

joovy®

Caboose Too Ultralight 0087X

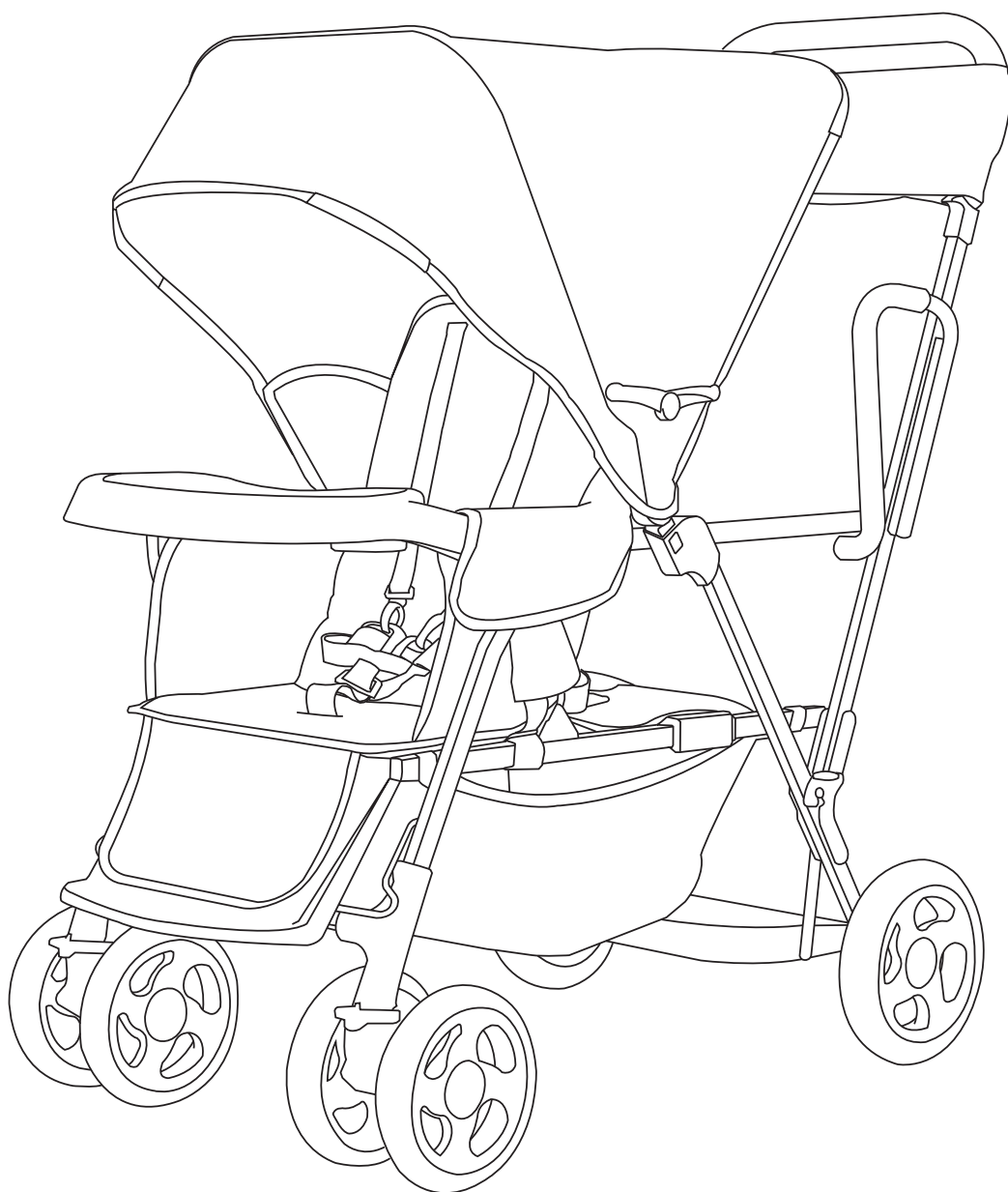

WARNING

Please read this instruction manual completely before using this stroller. Keep these instructions for future reference.

- Failure to follow these instructions could result in serious injury or death.
- NEVER leave child unattended.
- Avoid serious injury from falling or sliding out.
- Always use restraint system and ensure that all children are positioned according to these instructions.
- Keep all small parts out of reach of children while assembling the stroller.
- Be certain that the stroller is fully opened, all of the locking devices are engaged, and the parking device is engaged before allowing children near the stroller or any use.
- The parking device should always be engaged during the loading and unloading of children.
- The front seat is not suitable for a child under 3 months.
- The front seat is intended for a child up to a maximum weight of 45 lbs.
- The rear forward facing seat is not suitable for a child under 6 months.
- The rear forward facing seat is intended for a child up to a maximum weight of 45 lbs.
- The rear stand-on platform and the rear bench seat are designed for a child that is at least 2-1/2 years old, but LESS than 44 inches tall and 45 lbs.
- Use of the stroller with children totaling more than 90 lbs. will cause excessive wear and stress on the stroller and may cause a hazardous unstable condition.
- Never use this stroller to carry more than 2 children at the same time.
- Never allow a child to step on the footrest to get into or out of the stroller.
- Do not use the stroller on stairways or escalators.
- Do not add any attachment not specifically recommended by Joovy.
- Any load attached to the handle affects the stability of the stroller. Hanging purses, shopping bags, parcels, changing bags or other accessory items from handle bars or any other parts of the stroller may change the balance of the stroller and cause a hazardous unstable condition.
- The maximum weight that can be carried in the storage basket is 5 lbs. Excessive weight may result in a hazardous unstable condition.
- When installing an infant car seat onto the stroller, ALWAYS use the restraining strap to secure the infant car seat in place.
- The maximum weight that can be carried in each cup holder or the tray is 2 lbs.
- This product is not suitable for running or skating.
- Never allow your stroller to be used as a toy.
- Discard all packaging materials properly. Do not allow children to play with them.
- Check your stroller for loose rivets, snaps, worn parts, and torn material or stitching on a regular basis.
- Discontinue use of the stroller should it malfunction or become damaged.

Please do not return this product to the store

If you experience any difficulty with the assembly or use of this product, or if you have a question regarding these instructions, please contact our Customer Service Department at (877) 456-5049 between the hours of 8:30 am and 5:00 pm Central Time.

Please note: Styles and colors may vary.

1 Unpacking the Product

- Remove everything from the box and identify the parts using **Figure 1.1**. (not to scale)
A: stroller, **B:** caboose too rear seat **C:** canopy, **D:** rear axle, **E:** two rear wheels, **F:** two front wheels sets, **G:** tray, **H:** plastic cap, **I:** two small washers, **J:** four large washers, **K:** two spring washers, **L:** two snap pins, **M:** two hub caps **N:** infant car seat adapter (OPTIONAL), **O:** parent organizer (OPTIONAL), rain cover (OPTIONAL and not shown) and documents (not shown).
NOTE: The rear axle is attached to the rear frame. Detach the axle from the frame and remove the yellow foam padding. Extra parts may be included.
- Discard all packaging materials properly including plastic coverings.
- DO NOT allow children to play with any packaging materials.

WARNING

Adult assembly is required for this product. No tools required.

This package contains small parts. Keep all small parts away from children during assembly.

2 Unfolding

- Keep children away from stroller while unfolding.
- Release the folding lock located on the right side by lifting the lever off of the catch. **See Figure 2.1.**
- Lift up on the handle of the stroller until the frame snaps into its open locked position.
CAUTION: While unfolding the stroller, be careful to keep your fingers from being pinched by moving parts.
NOTE: Remove packing foam from rear frame assembly to ensure stroller locks in the open position.
- Lock the safety latch. **See Figure 2.2.**
- Ensure that the safety latch is secured before ANY use of the stroller.

WARNING

ALWAYS secure the safety latch on the side of the stroller when it is in the unfolded use position. This will prevent collapse of the stroller should the handle trigger locks be accidentally opened.

Possible pinching hazard - Be careful when unfolding the stroller.

3 Installing Rear Wheels

- Turn stroller upside down.
- Insert the rear axle through both holes under the stand-on platform. **See Figure 3.1.**
- Install the parts in the following order. **See Figure 3.2.**
 - Small washer
 - Wheel (brake cluster facing inward)
 - Large washer
 - Spring washer
 - Large washer
- Push snap pin through the hole in the axle until it snaps in place.
- Push the axle as far as it will go toward the opposite side of the stroller.
- Next turn the stroller onto its side, with the already assembled wheel toward the floor. Place the axle onto the center of the solid surface of the red plastic cap so that the axle is pushing upwards for easier installation. **See Figure 3.3.**
- Repeat the installation steps for the other wheel.
- Push the hubcaps on until they snap in place. **See Figure 3.4.**

4 Installing Front Wheels

- Place the front wheel sets onto the front wheel posts until they click in place. **See Figure 4.1.**
- Pull on the wheel sets to ensure they are installed properly.

5 Front Wheel Locks

The front wheels can be set to swivel or lock.

- To lock the front wheels, rotate each wheel set so that it points forward.
- Pull up on the red locking lever to engage the swivel lock. **See Figure 5.1.**
- To unlock the wheels (swivel mode) push down on the lever.

6 Installing and Operating the Canopy

- Position the canopy with the sun visor forward.
- Insert the canopy attachments into the frame mounts on BOTH sides. Ensure they snap into place. **See Figure 6.1.**
- The canopy can be adjusted forward and back, and locked open using the canopy locks on BOTH sides. **See Figures 6.2 and 6.3.**
- To close the canopy, unlock the sides, then collapse. **See Figure 6.4.**
- To remove the canopy, press the lock buttons on BOTH sides of the canopy and pull up. **See Figure 6.5.**

WARNING

Possible pinching hazard - Be careful when closing and opening the side hinges so as not to pinch your fingers.

7 Attaching/Detaching the Front Tray

- To attach the front tray, slide the tray onto BOTH red mounts until they snap in place. **See Figure 7.1.**
- To remove tray, press the lock buttons on BOTH mounts and pull forward. **See Figure 7.2.**

WARNING

The child tray is not a restraint device. Always secure your child with the restraint system. Never lift the stroller by the child tray. Use caution when attaching the child tray when there is a child seated in the stroller.

8 Rear Wheel Brakes

- Always engage rear brakes before placing child in or removing a child from the stroller.
- To engage the brakes, push down on either of the red brake levers until the brake snaps in place. **See Figure 8.1.**
- Check that BOTH wheel brakes are properly engaged.
- To release the brakes, lift up on the brake lever. **See Figure 8.2.**

WARNING

Always engage the parking brake when the stroller is not being pushed so that it will not roll away. Never leave stroller unattended, especially on a hill or incline, as the stroller may tip over or slide.

9 Adjusting the Footrest

The footrest can be adjusted fully up or down.

- To lock the footrest upright, pull up on the footrest and lift up on the support bar. Ensure it is locked in place. **See Figure 9.1.**
- To put the footrest into the down position, pull up on the footrest, push down on the support bar, then release the footrest. **See Figure 9.2.**

WARNING

Never allow a child to step onto the footrest in either position in order to get into or out of the stroller. This may cause the stroller to tip over and injure the child.

10 Securing the Front and Caboose Too Rear Seated Children

- There are three height adjustment positions for the shoulder harness. Adjust the height to the closest height above your child's shoulders.
- To remove the shoulder harness, turn the plastic ends sideways and push them through the slots in the seatback. Reattach the harness at the proper height by reinserting the plastic ends through the slots. **See Figure 10.1.** Ensure both straps are the same height.
- To remove the crotch strap, slide the strap through the small opening in the metal D-ring. Reattach by pushing the metal-D ring through the slot in the seat, wrap the strap around the tube under the seat bottom. Slide the strap through the small opening of the metal D-Ring and pull the strap to secure it to the tube. **See Figure 10.2.**
- Remove the waist straps by sliding the strap through the small opening in the metal D-ring, then pull the strap away from the seat. **See Figure 10.3.** Reattach by pushing the metal-D ring through the slot in the seat, wrap the strap around the seat back frame tube. Slide the strap through the small opening of the metal D-Ring and pull the strap to secure it to the tube. Repeat for the other end of the strap.
- To unlatch the buckle press the center button and remove the male ends of each buckle. **See Figure 10.4.**
- To separate the shoulder harness from the waist harness, simply slide the waist buckles from the shoulder buckles. **See Figure 10.5.**
- Carefully place the child in the seat with the shoulder straps over their shoulders and chest. Then place the crotch strap between the child's legs.
- Bring the waist straps around the child's waist and insert the male ends of the waist buckles into the shoulder buckles. **See Figure 10.6.** Then push the shoulder/waist latch posts into the crotch buckle until all parts snap into place. **See Figure 10.7.**
- Tighten the waist belt to be snug around the child's waist.
- The shoulder, waist, and crotch straps may be adjusted using the sliding plastic rings on these straps.

WARNING

The front seat is not suitable for a child under 3 months. The rear seat is not suitable for a child under 6 months. Avoid serious injury from falling or sliding out. Always use the restraint system.

11 Front Seat Recline Positioning

The front seat has 3 recline positions. This seat should only be used for a child that is at least 3 months old. For children between 3 and 6 months, only use the fully reclined position.

- To place the seat in the first upright position, squeeze the recline bars located on the back of the seat, and move the seat to the upright position. Check to ensure that the recline mechanism has engaged and the seat does not move. **See Figure 11.1.**
- To recline the seat, squeeze the recline bars and move the seat to either the second (middle) or third recline positions. Again, check to ensure that the recline mechanism has engaged, and that the seat does not move.

WARNING

Whether the seatback is upright or reclined, ALWAYS make certain that the recline mechanism is engaged before placing the child into the seat.

12 Using the Stand-On Platform

- Push the bench seat to its most forward position.
- Position the canopy to its most forward position.
- Position the child on the platform on the back of the stroller. Be sure that the child is facing forward and BOTH of their hands are holding the handles on the frame.
- Be sure that BOTH of the child's feet are fully on the platform at all times.
- You may need to adjust the recline position of the seat to allow for more room for the child to stand.

WARNING

The rear stand-on platform and the rear bench seat are designed for a child that is at least 2-1/2 years old but LESS than 44 inches tall and less than 45 lbs.

Use of the stroller with two children weighing more than 45 pounds each, or children totaling more than 90 pounds, will cause excessive wear and stress on the stroller and may cause a hazardous unstable condition.

NEVER allow a standing child to use the canopy as a hand hold.

NEVER use this stroller to carry more than 2 children at the same time.

13 Using the Rear Bench Seat

- Push the bench seat to its most rearward position.

NOTE: There are webbing straps attached to the bottom of the rear seat pad. These straps will lock the seat into the most rearward position. To lock the seat, pull the straps from EACH side of the pad and loop them around the frame as shown, then snap them together.

See Figure 13.1.

- To slide the seat forward, undo EACH snap and reattach the webbing to the underside of the seat pad using the Velcro® attachments.
- Position the canopy to its most forward position.
- To unlatch the buckle press the center button and remove both latch posts.
- Have the child sit on the bench seat facing backward with their feet on the platform.
- You may need to adjust the recline position of the seat to allow for more room for the child to sit.
- Place the crotch strap between the child's legs.
- Push the waist latch posts into the crotch buckle until all parts snap into place. **See Figure 13.2.**
- Adjust the seat belt to be snug around the child's waist.
- Be sure that BOTH of the child's feet are fully on the platform at all times.
- Be sure that BOTH of the child's hands are holding the handles on the frame.

WARNING

NEVER allow a rear seated child to use the canopy as a hand hold.

14 Storage Basket

The maximum weight that can be carried in the storage basket is 5 lbs.

15 Removing the Rear Bench Seat Waist Strap from Stroller

- On the stroller, unsnap both waist straps from the crotch strap on the rear 3-point harness. Leave the crotch strap in place to use with the Caboose Too Rear Seat.
- To remove the waist straps, locate one end of the strap where it attaches to the front seat tube. Slide the strap through the small opening of the metal D-ring and pull the strap away from the front seat. Repeat for the other strap. **See Figure 15.1.**
- Store waist straps in a safe place for future use.

16 Attaching the Caboose Too Rear Seat

- Place the seat fabric in position over the sliding rear bench seat so that the seat is facing toward the front of the stroller.
NOTE: It is not necessary to remove the existing fabric pad from the bench seat.
- Push the rear seat crotch strap (with the buckle) up through the slot in the Caboose Too Rear Seat. **See Figure 16.1.**
- Locate the 2 harness loops on the upper rear of the Caboose Too Rear Seat (one on each side). Snap them around the handle bar above the rear handles. **See Figure 16.2.**
- Slide the front fabric pocket, located under the front of the Caboose Too Rear Seat, over the front of the bench seat. **See Figure 16.3. (shows the underside of the bench seat)**
- Locate the 2 long straps on the lower rear of the Caboose Too Rear Seat (one on each side). Wrap each strap around the outside of the stroller handle bar and feed them through the loops on the back of the seat. Securely snap the straps together. **See Figure 16.4.** If necessary, pull the webbing near the male end of the buckle to tighten.
- Near the front sides of the Caboose Too Rear Seat are 2 Velcro® straps (one on each side). Secure these straps around the lower horizontal frame bar on both sides. **See Figure 16.5.**
- Wrap the left and right armrests of the Caboose Too Rear Seat around the upper horizontal frame (on each side). Securely snap together both snaps on each side. **See Figure 16.6.**
- Check that the seat is securely in place.

17 Caboose Too Rear Seat Seatback Positioning

The seat back can be adjusted to any position from fully upright to reclining. This seat should only be used for a child that is at least 6 months old.

- To recline the seat, release the adjustment lock tab from its locked position by pulling it away from the seat back. Continue to pull this lock tab downward to adjust the seat back to the desired position, then re-engage the lock tab. **See Figure 17.1.**
- To adjust the seat back to a more upright position, release the adjustment lock tab from its locked position. Then simply pull up on the adjustment strap ring until the seat back is in the desired position and re-engage the lock tab. **See Figure 17.2.**

WARNING

The rear seat is not suitable for children under 6 months.
ALWAYS ensure that the seatback is secured into its position.
Push down on the seatback to be sure it is secure.
NEVER adjust the seatback when the child is in the seat.

18 Removing the Caboose Too Rear Seat

- Unsnap the waist and shoulder straps from the crotch strap. Leave the crotch strap in place to use with the stroller rear bench seat.
- Unwrap the left and right armrests of the Caboose Too Rear Seat from around the upper horizontal frame (on each side). Unsnap both snaps on each side. **See Figure 18.1.**
- Near the front sides of the Caboose Too Rear Seat are 2 Velcro® straps (one on each side). Pull these straps apart. Repeat on the other side. **See Figure 18.2.**
- Locate the 2 straps on the upper rear of the Caboose Too Rear Seat (one on each side). Unsnap them from around the handle bar above the rear handles. **See Figure 18.3.**
- Locate the long straps on the lower rear of the Caboose Too Rear Seat. Unsnap the straps and unwrap each strap from around the outside of the stroller handle bar by feeding them through the loops on the back of the seat. **See Figure 18.4.**
- Push the rear seat crotch strap (with the buckle) through the slot in the Caboose Too Rear Seat (**See Figure 18.5**) and pull the Caboose Too Rear Seat off of the rear bench.

19 Installing the Rear Bench Seat Waist Strap

- To install the rear bench waist strap, locate one end of the waist strap where it has a metal D-ring at the end.
- Wrap the strap around the front seat rear tube. Slide the strap through the small opening of the metal D-ring and pull the strap to secure it to the tube. Repeat for the other end of the strap. **See Figure 19.1.**
- Push the waist latch posts into the crotch buckle until all parts snap into place.

20 Folding the Stroller

- Keep children away from stroller while folding.
 - Remove any infant car seat. The stroller can be folded with the infant car seat adapter and the Caboose Too Rear Seat in place.
 - Close the canopy and push it forward.
 - Put the front seat and Caboose Too Rear Seat (if attached) into their most upright position.
 - Make sure both rear wheel brakes are set to their locked positions.
 - Lock BOTH front wheel sets in place with locking levers facing forward.
 - Unlock the safety latch on the lower left side of the stroller.
 - Pull upward on the trigger mechanisms on both sides of the stroller and push the handle fully forward. **See Figure 20.1.**
- CAUTION:** While folding the stroller, be careful to keep your fingers from being pinched by moving parts.
- Engage the fold lock on the right side of the stroller over the mounting post. **See Figure 20.2.**

WARNING

ALWAYS keep children away from the stroller when folding.
Possible pinching hazard - Be careful when folding the stroller.

21 Using the Stroller with an Infant Car Seat (OPTIONAL)

NOTE: See insert for a list of specific compatible car seat models.

- Remove the front tray and install the infant car seat adapter on the same mounts. Ensure it is secure on BOTH sides. **See Figure 21.1.**
- Push the canopy to its most rearward position.
- ADJUST THE SEAT TO ITS SECOND (MIDDLE) POSITION.
- Remove the infant car seat from its base and place it onto the front seat of the stroller so it is in a REAR FACING POSITION. Position the “head” end toward the front, resting on the infant car seat adapter. Position the “feet” end on the seatback - but NOT on the top edge of the seatback. **See Figure 21.2.**
- Buckle the red restraining straps over the LOWEST part of the infant car seat (the straps are located in the pockets on the side of the seat) Adjust the straps so they are tight around the infant car seat but AWAY from the child’s neck. Pull up on the infant car seat to be sure it is secure. **See Figure 21.3.**
- To remove the infant car seat from the stroller, unlock the restraining strap buckle by pressing the button and both side releases. **See Figure 21.4.**
- Return the restraining straps to their pockets.

WARNING

ALWAYS install the infant car seat so that the child is facing toward the rear (handle) of the stroller with the restraining straps secured.

ALWAYS position the infant car seat so that it is securely placed down inside the infant car seat adapter frame.

ALWAYS position the infant car seat so that it is resting ON the seatback, but NOT on the top of the seatback. The seatback must be in the second (middle) position.

NEVER position the restraining straps on or near the child’s neck as this may result in strangulation.

The infant car seat adapter is for use ONLY with specific infant car seat models. See insert for specific models. DO NOT use other infant car seat models.

22 Installing the Parent Organizer (OPTIONAL)

- Separate the Velcro® attachments in the open slot of the Organizer.
- Orient the Organizer so the cup holders are facing toward the front of the Stroller. **See Figure 22.1.**
- Stretch the Organizer outward and slide it down over the handlebar until it just comes into contact with the red trigger releases.
- Press the Velcro® attachments together to secure it in place.

WARNING

For use **ONLY** on the Joovy Caboose Too Ultralight Stroller. **NEVER** carry hot beverages or open containers in this product.
Maximum weight for Organizer is 5 lbs.

23 Installing the Rain Cover (OPTIONAL)

- The canopy on the stroller should be in an open position, but with the visor closed.
- Place the rain cover over the stroller with the long flap toward the rear of the stroller. Make sure the front seam is over the front edge of the canopy.
- Pull the long flap through the rear handlebars just above the red trigger mechanisms. Pull each of the rear sides of the rain cover around the outside of the handlebars.
- Pull the long flap down and secure the 3 Velcro® attachments around the vertical frame to secure this long flap in place. Do this for both sides.
- Pull the rain cover down toward the wheels and attach the Velcro® straps around the frame corner on BOTH sides.

WARNING

For use **ONLY** on the Joovy Caboose Too Ultralight Stroller. **Never** leave this cover in place with child in stroller when exposed to direct sun or high temperature, as temperature inside may be excessive. This product is not a toy. **DO NOT** allow children to play with it.

Maintenance

All of the fittings, snaps, locks, rivets, and other hardware and plastic parts on the stroller should be inspected periodically to ensure that they are secured properly and not damaged or malfunctioning. The safety harness, as well as all other straps and fabric items and their stitching should also be inspected periodically to ensure that they are secured properly and not loose, torn or otherwise damaged. All moving parts, such as wheels, brakes, and hinges should also be checked periodically to ensure they are operating properly.

Any missing, broken, or worn components should be replaced immediately, and the stroller should not be used until they are replaced. Only original manufacturer's components should be used. If needed, please contact Joovy at our toll-free phone number.

Cleaning

The fabric material on this stroller can be cleaned using mild household soap or detergent and warm water on a sponge or clean cloth. Always allow the fabric to completely air dry before using the stroller.

The frame and wheels should always be kept clean and free of dirt and foreign matter, especially after operating the stroller in rain, snow, or other harsh environments. Use a sponge or cloth dampened with warm water and a mild household soap or detergent to clean the wheels after such use.

SATISFACTION GUARANTEED

We want you to be completely satisfied with your purchase of this product. Should you experience any difficulty in assembling or using this product, or if you have any questions, please contact our Customer Service Department at (877) 456-5049 between the hours of 8:30 am and 5:00 pm Central Time.

Please log onto www.joovy.com to register your new Joovy product.

joovy®
Caboose Too Ultralight
0087X

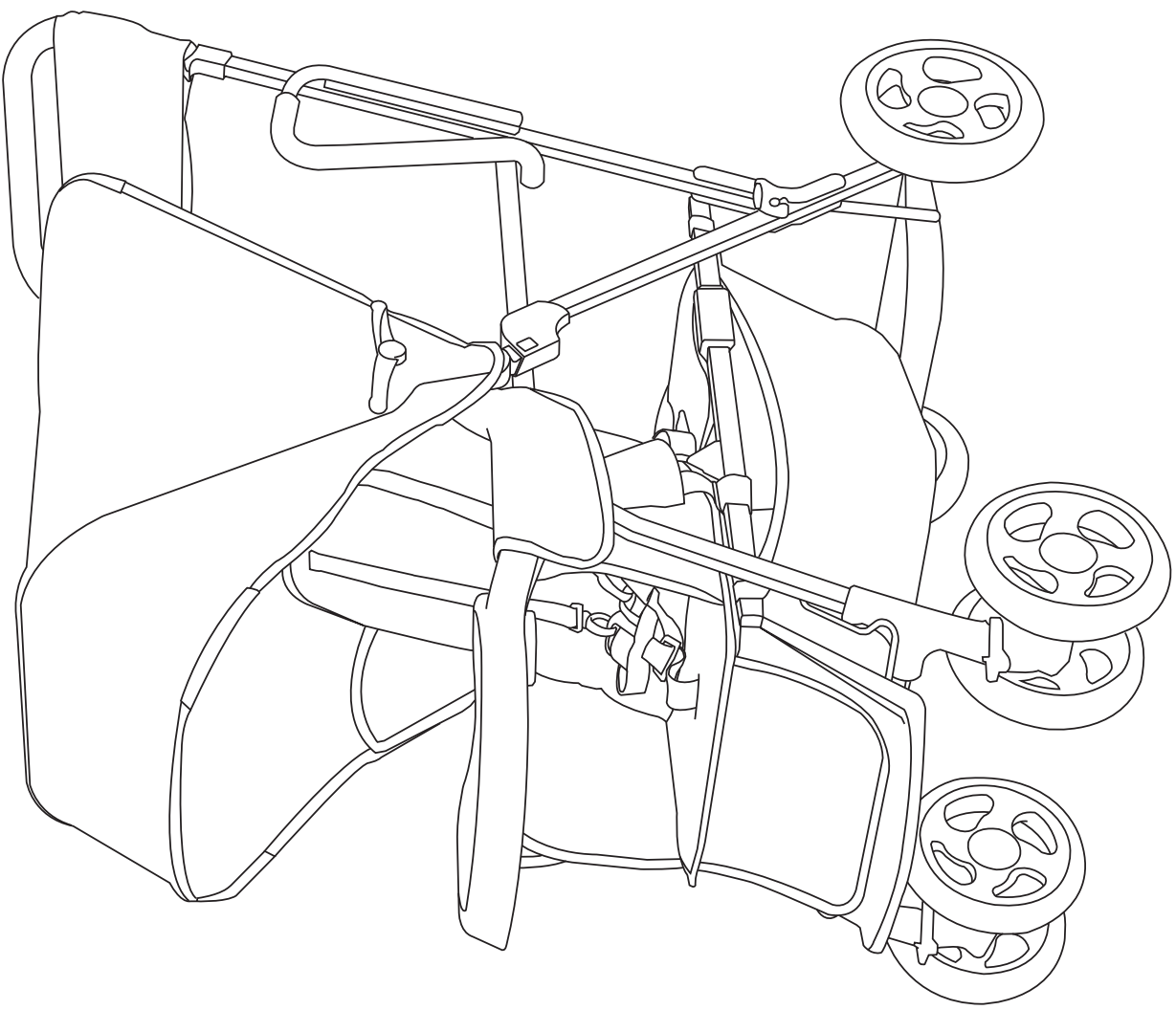

©joovy 2013 • Document Version 110513

1.1

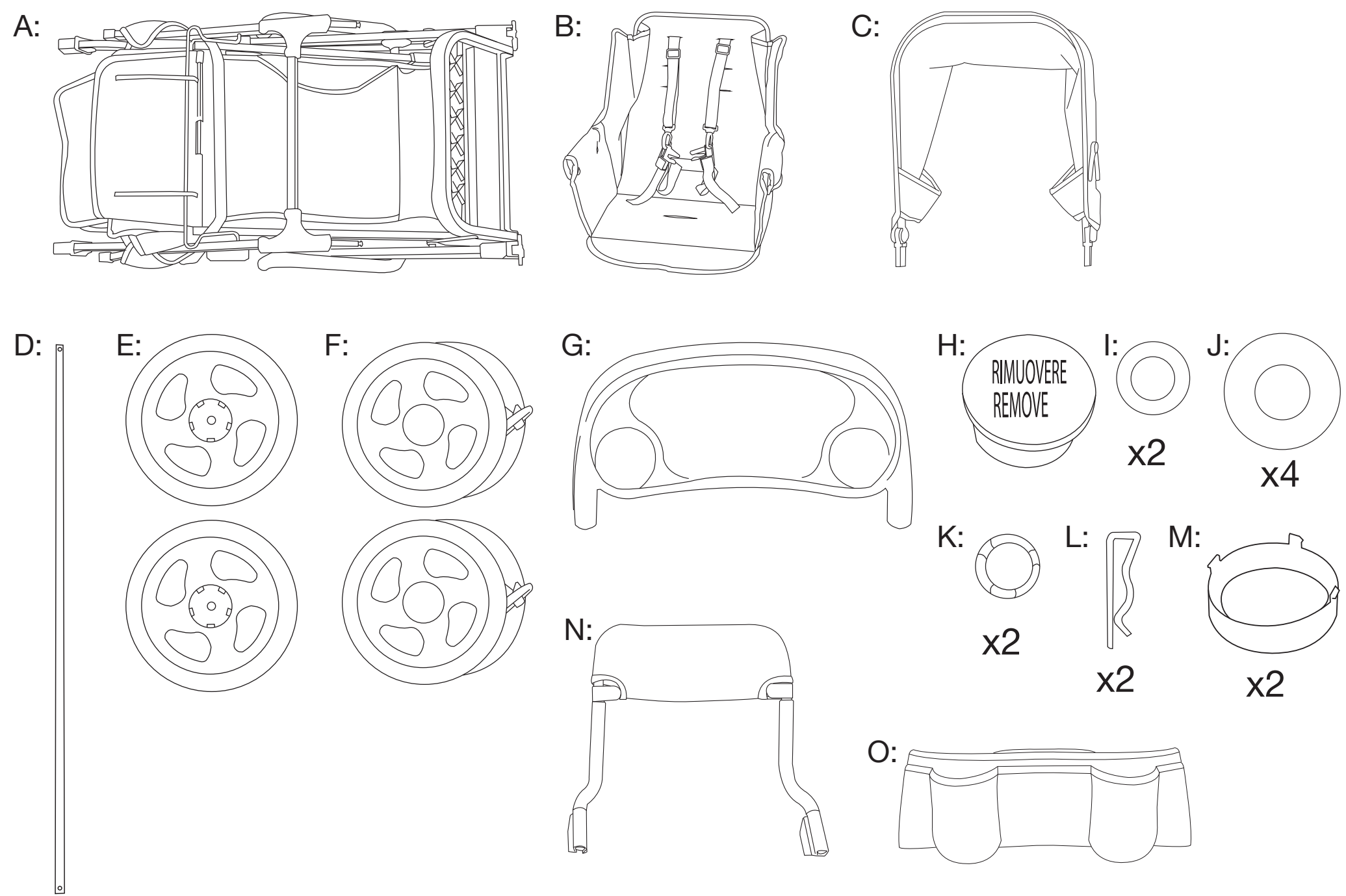

2.1

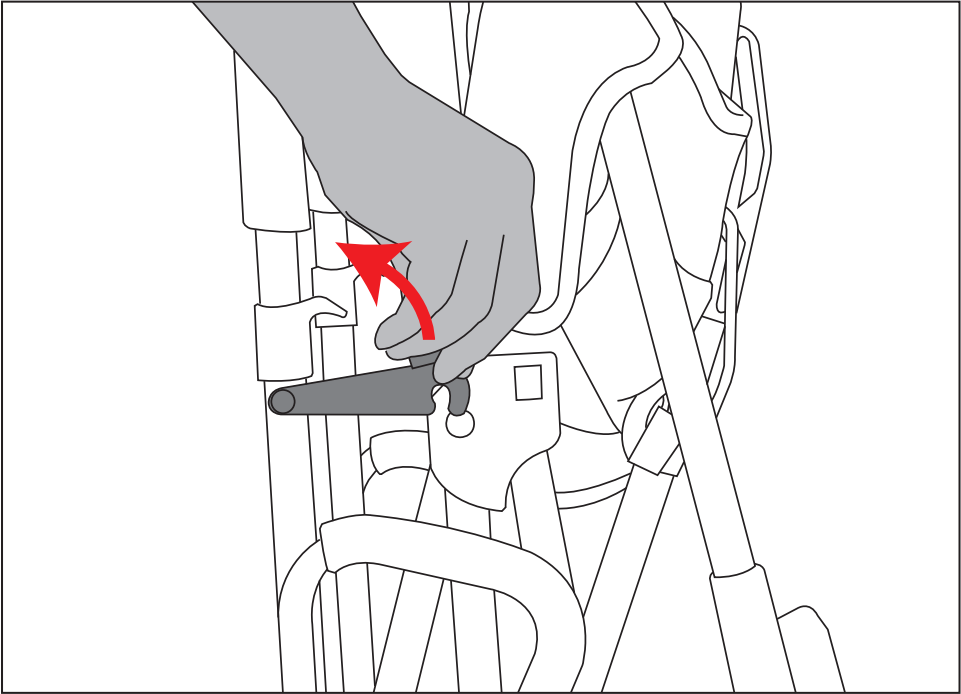

2.2

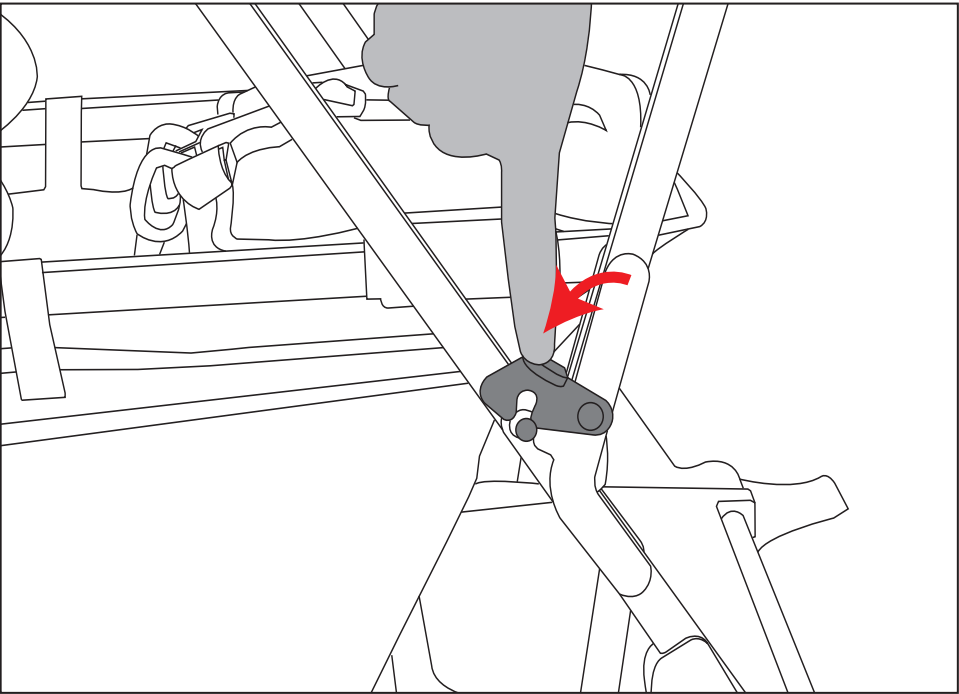

3.2

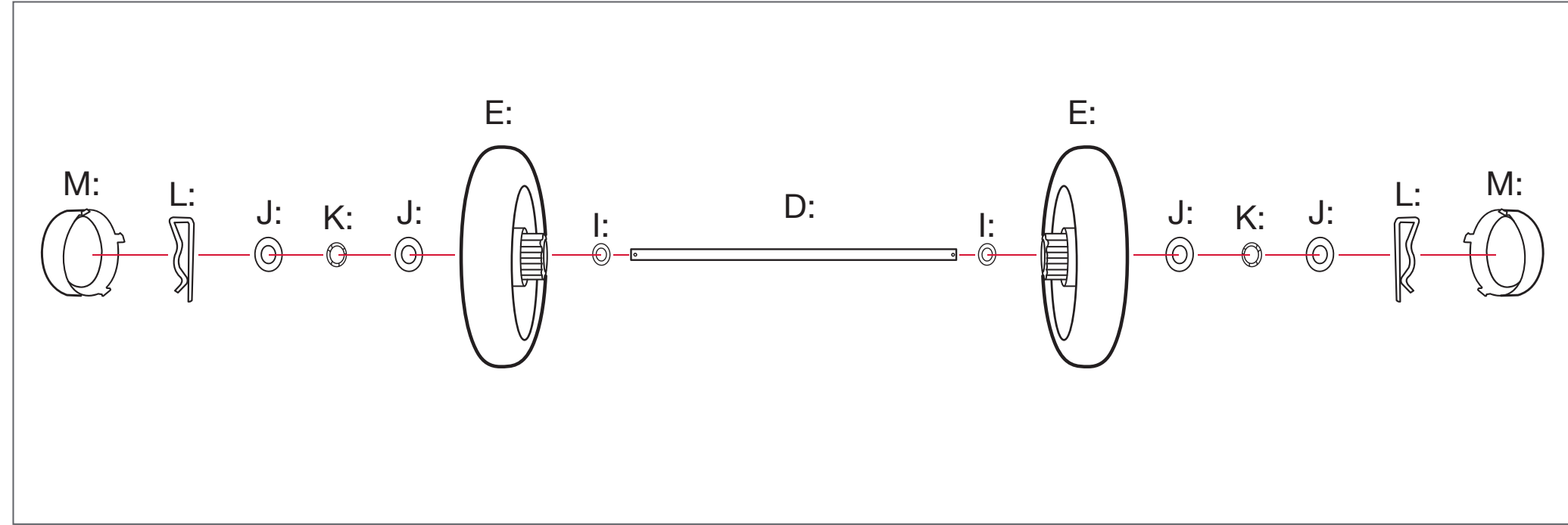

3.1

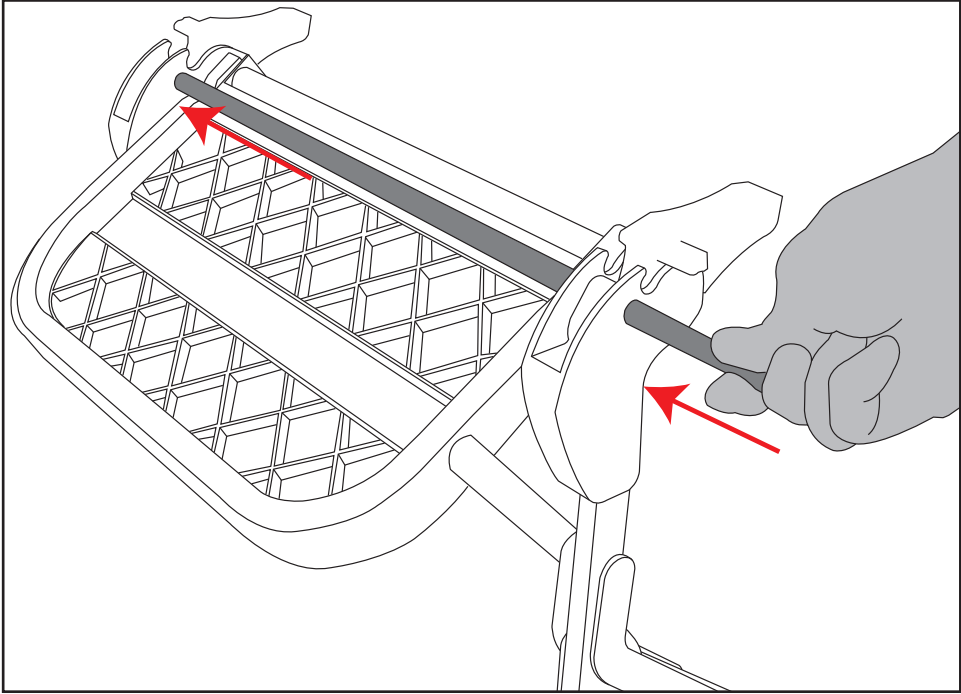

3.3

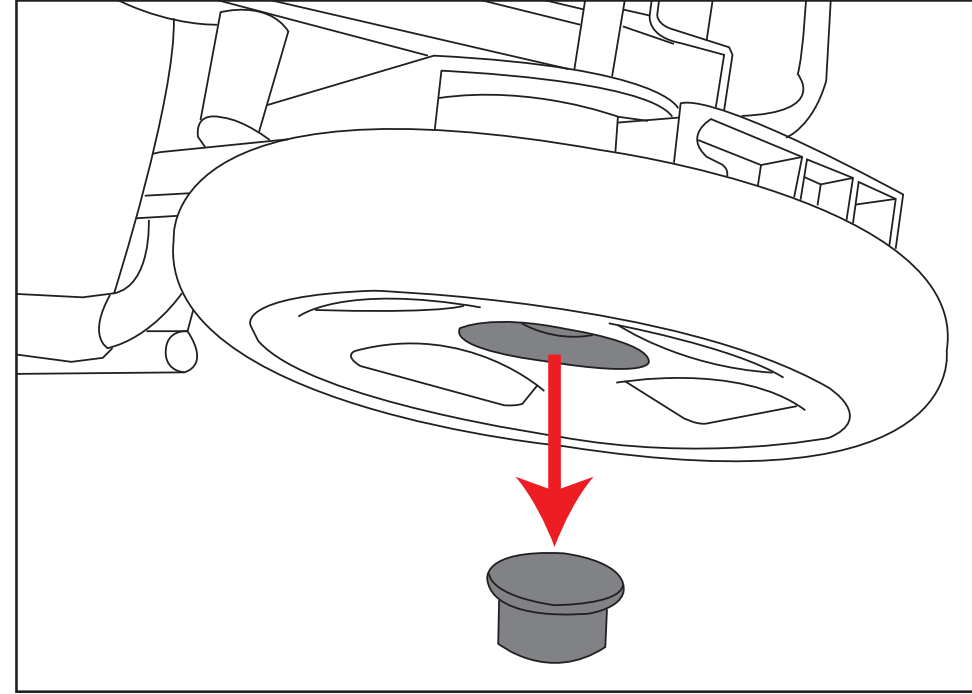

3.4

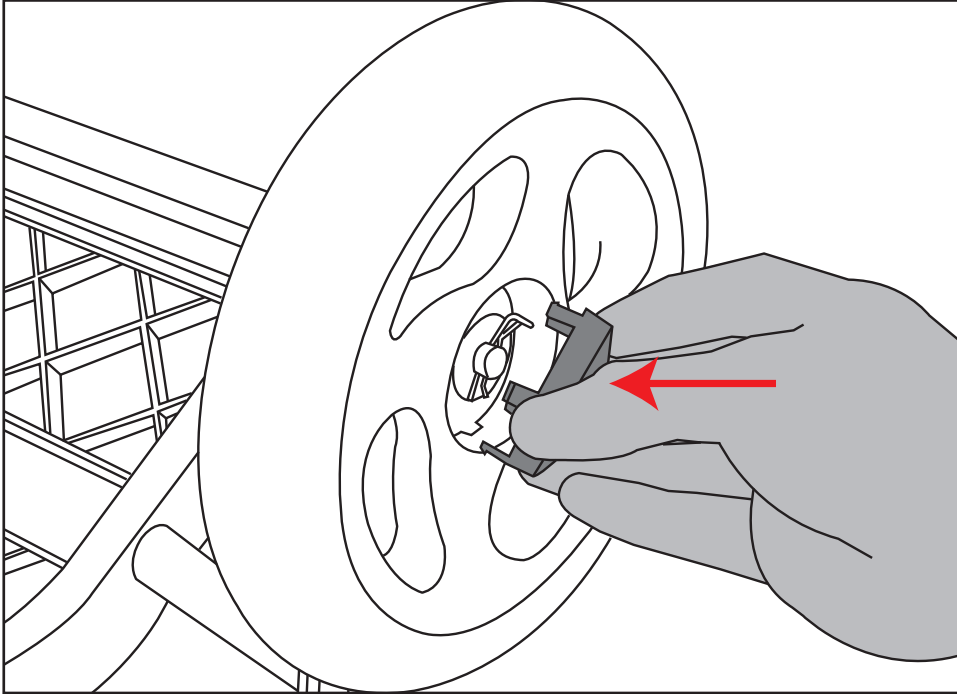

4.1

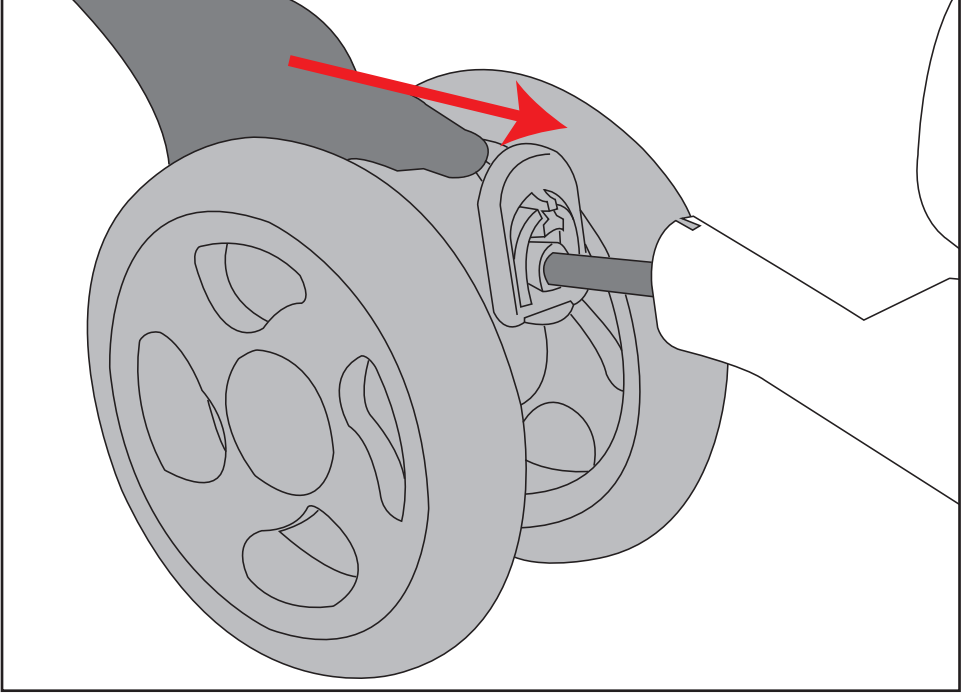

5.1

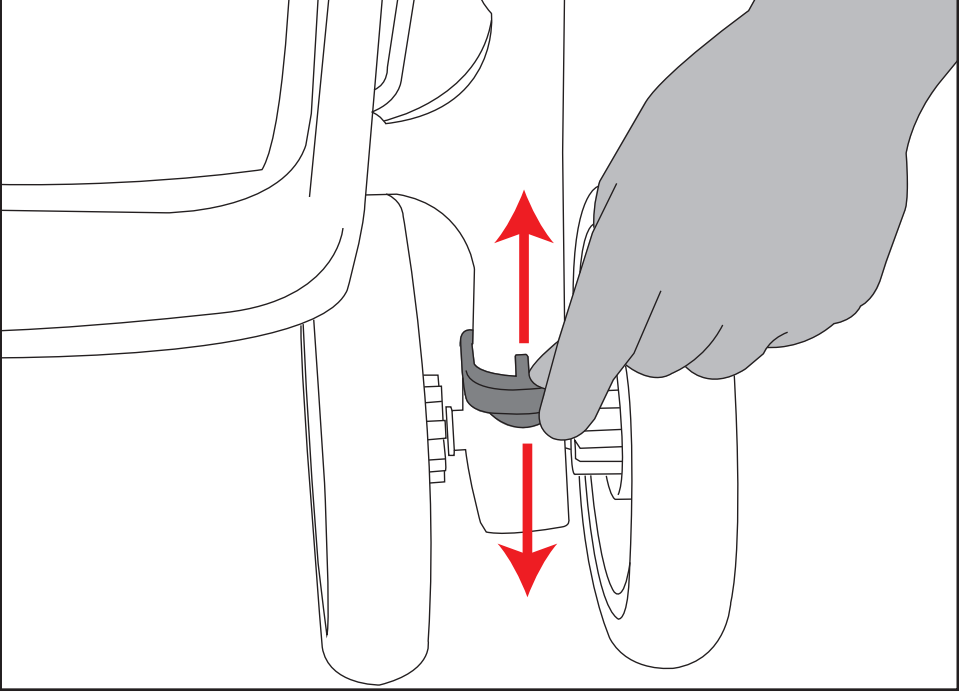

6.3

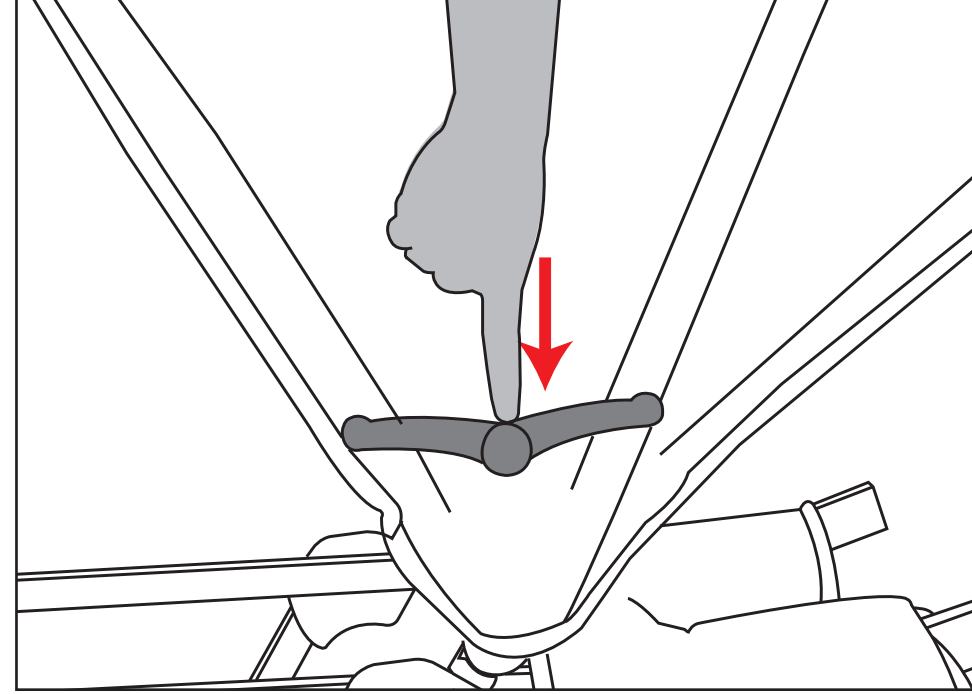

6.4

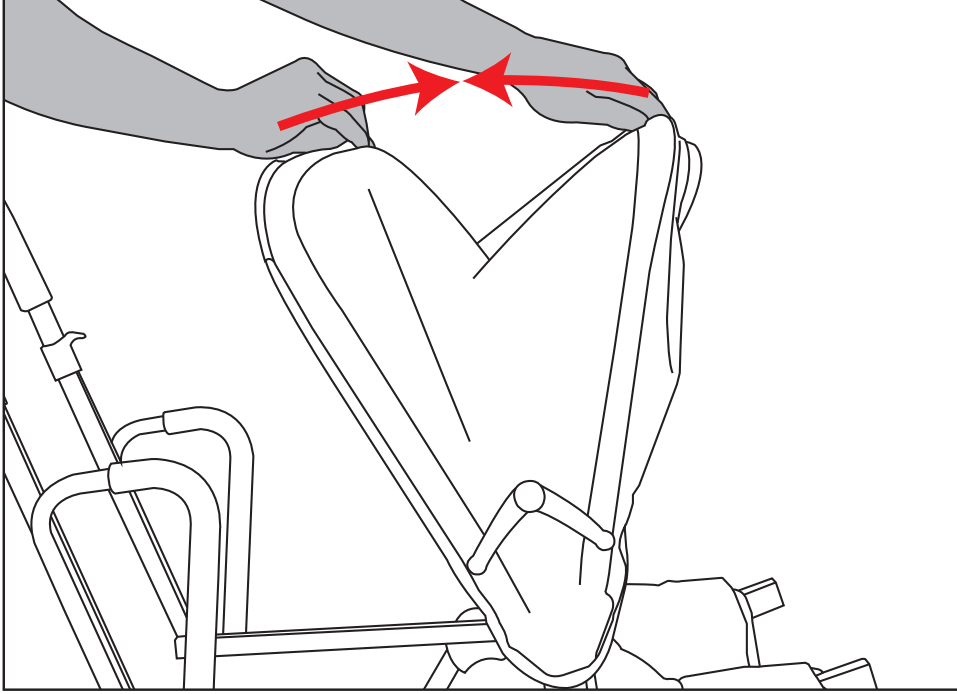

6.1

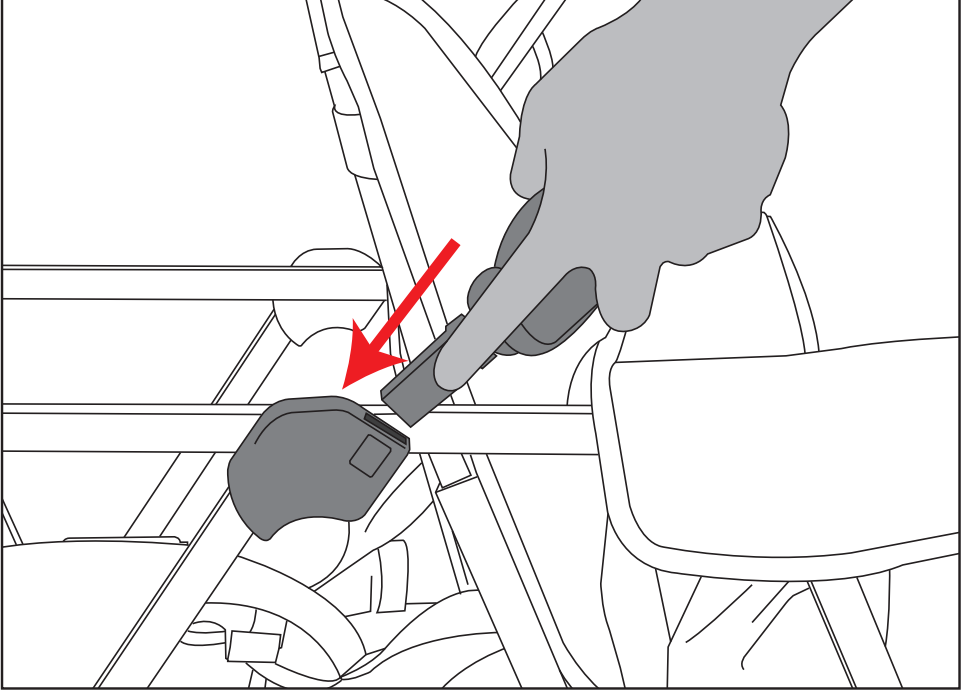

6.2

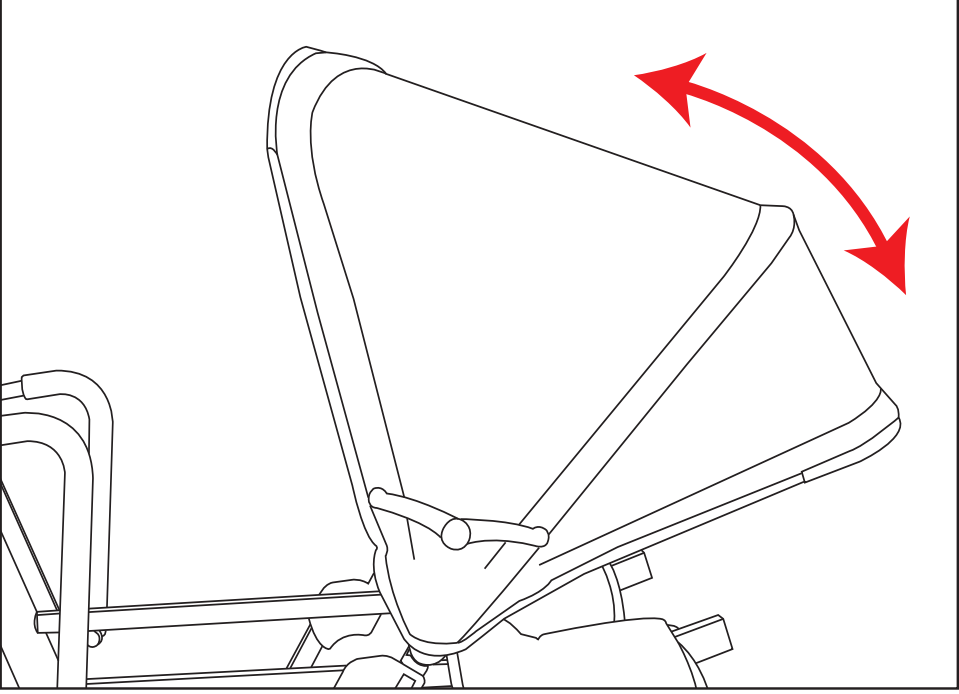

6.5

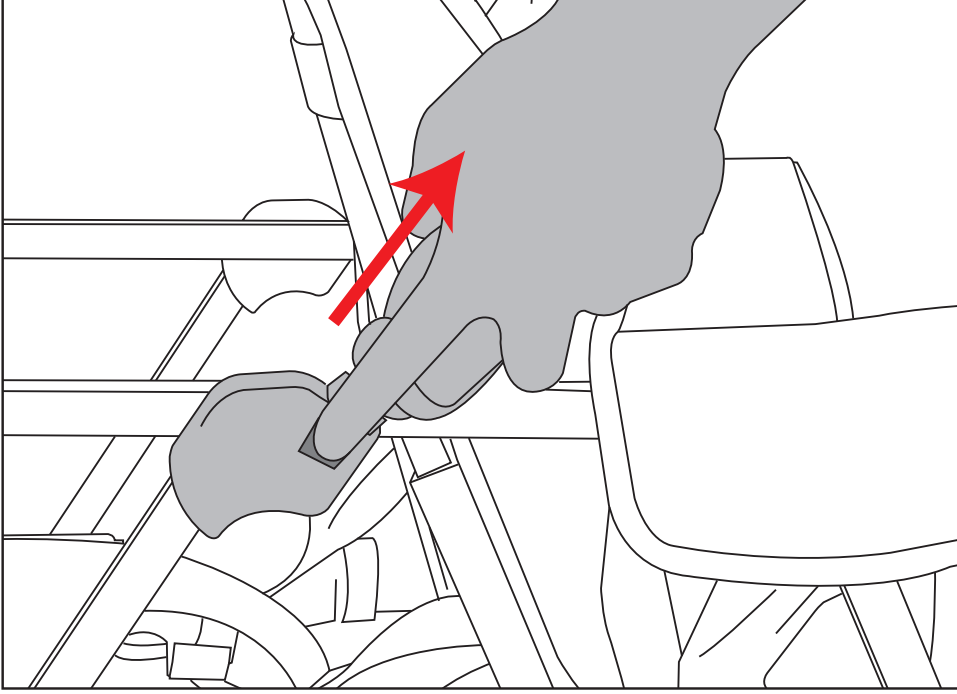

7.1

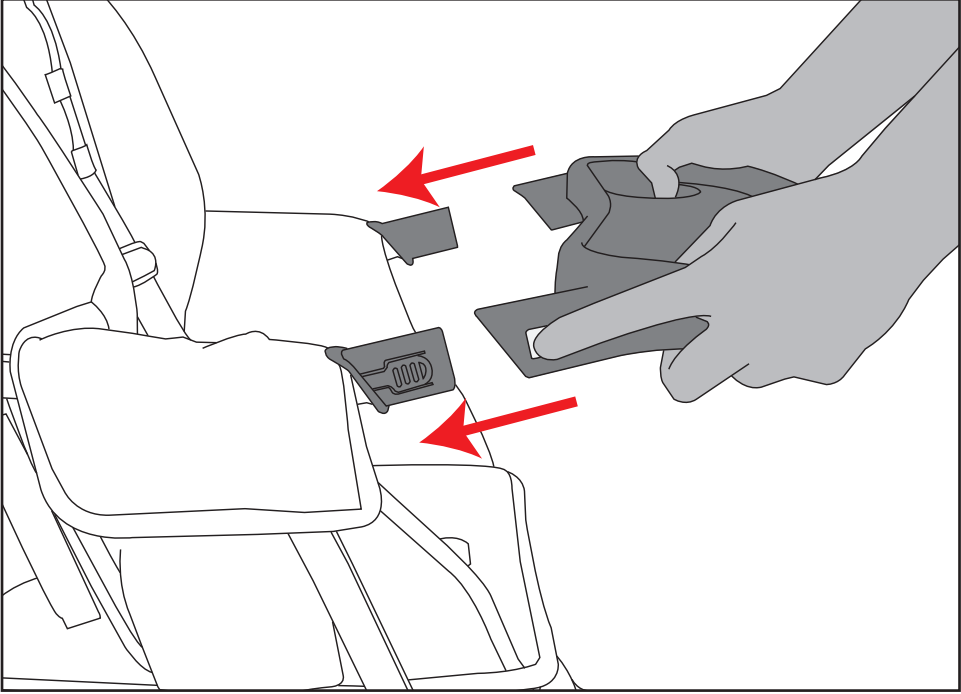

7.2

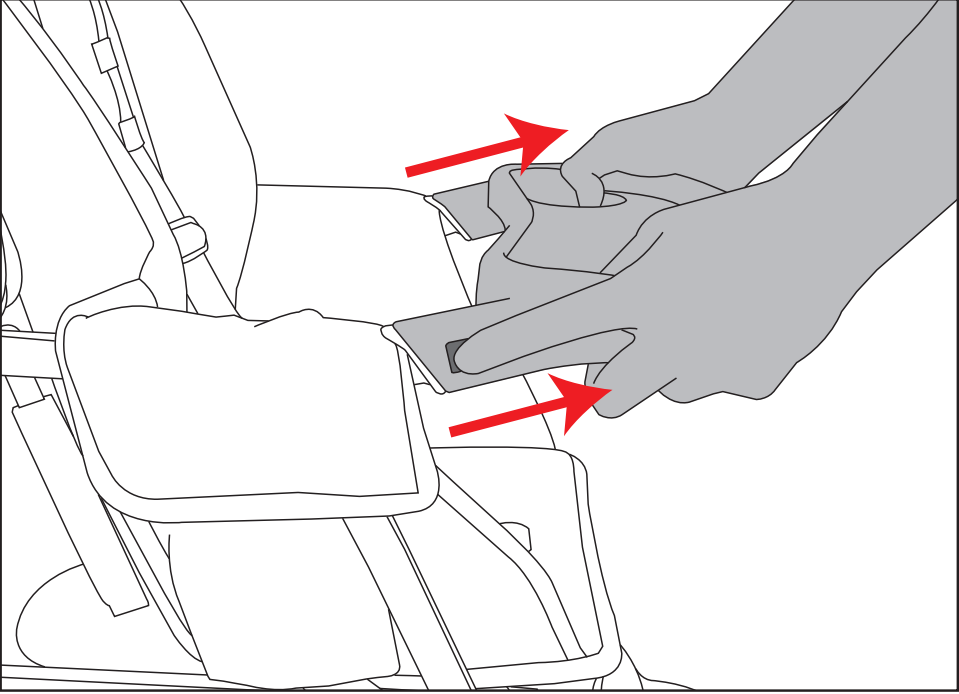

8.1

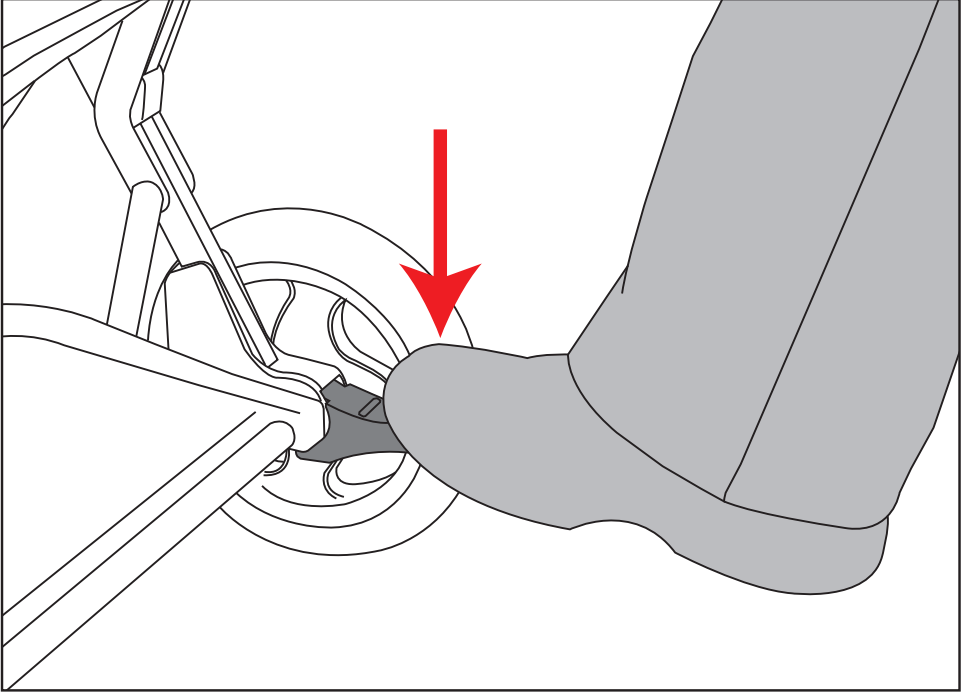

8.2

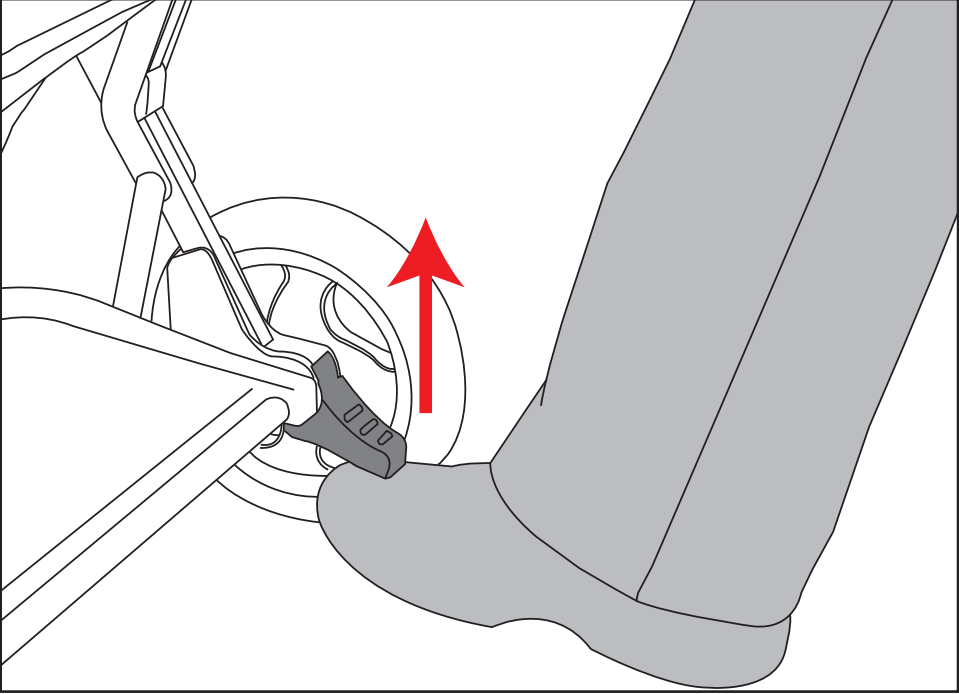

9.1

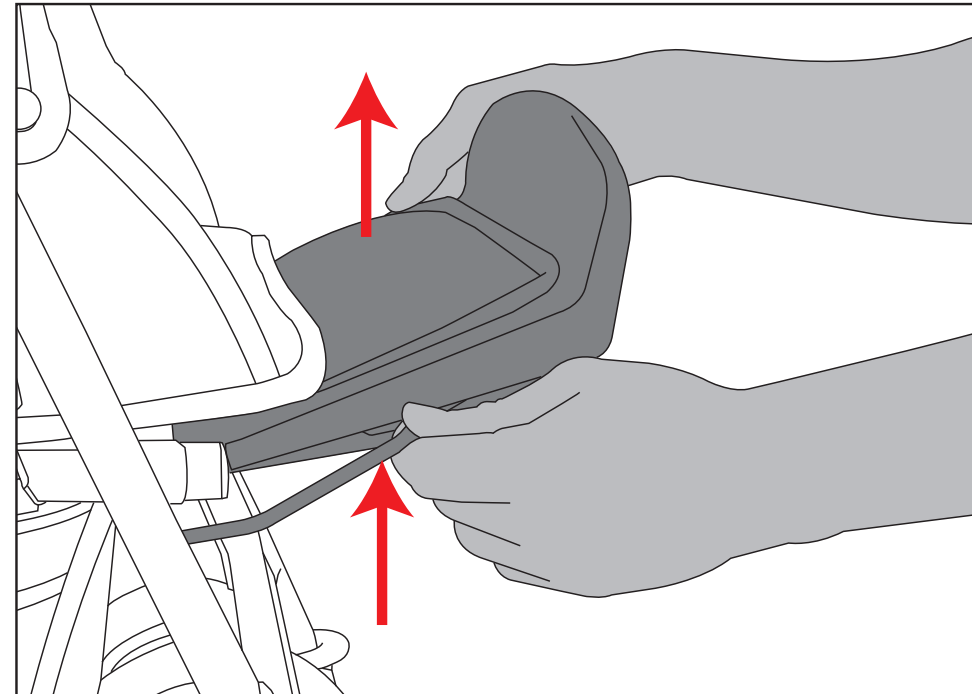

9.2

