

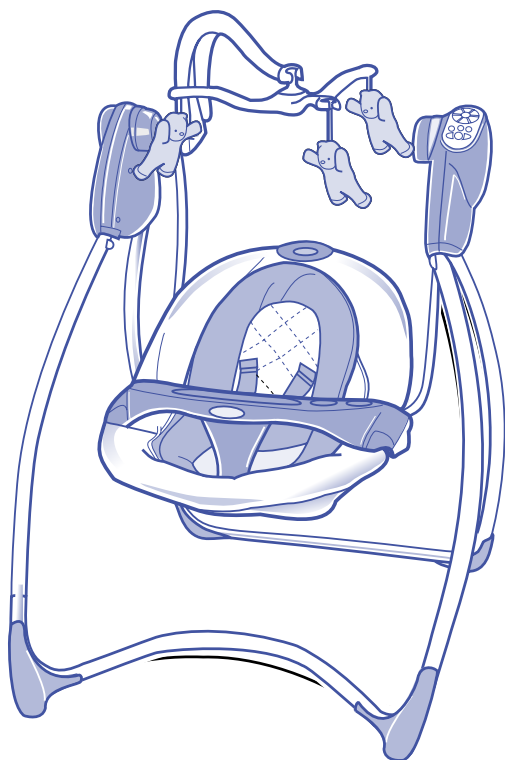

# Lovin' Hug



INSTRUCTIONS  
INSTRUCTIONS  
BEDIENUNGSANLEITUNG  
INSTRUCTIES  
ISTRUCCIONES  
ISTRUZIONI  
INSTRUÇÕES

UTASÍTÁSOK  
INŠTRUKCIE  
VEJLEDNING  
ANVISNINGAR  
OHJEET  
INSTRUKSJONER  
ИНСТРУКЦИЯ

INSTRUKCJA  
ΟΔΗΓΙΕΣ  
POKYNÝ  
ИНСТРУКЦИИ  
INSTRUCȚIUNI  
KASUTUSJUHISED  
INSTRUKCIJA

INSTRUKCIJA  
إرشادات  
UPUTE  
UPUTSTVA  
NAVODILA  
TALIMATLAR

**WARNING IMPORTANT!**  
**RETAIN FOR FUTURE REFERENCE**  
**READ CAREFULLY**

## To secure your child

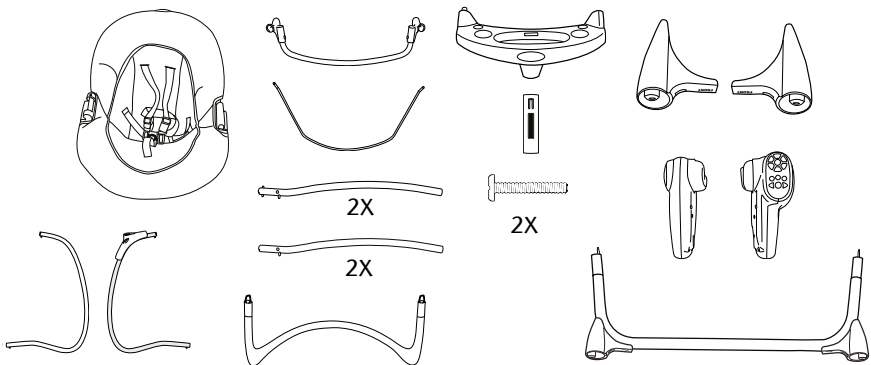

### ACCESSORIES (certain models only)

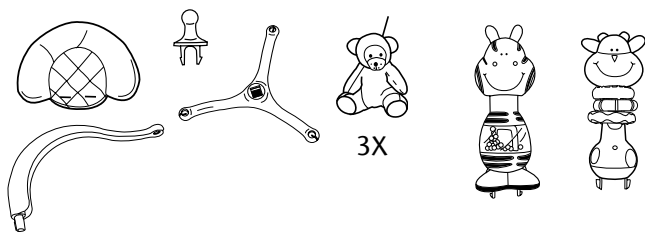

## Assembly

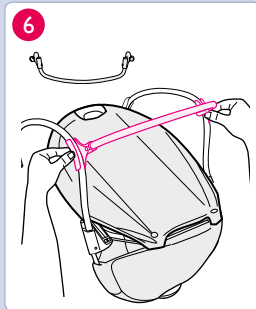
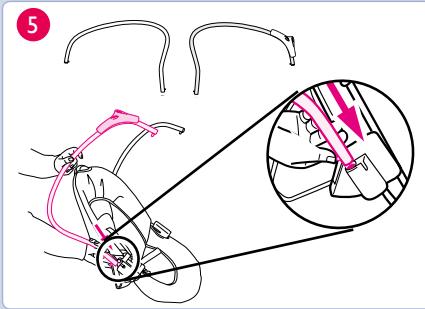
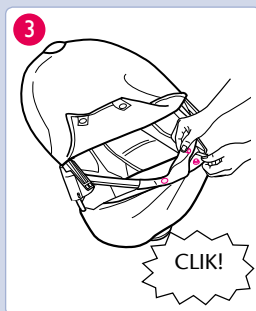
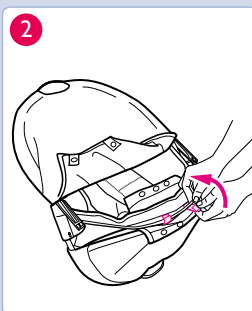
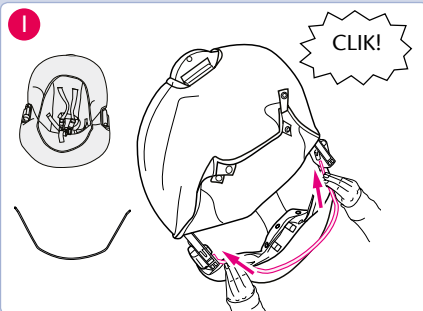

## Attaching Tray

7

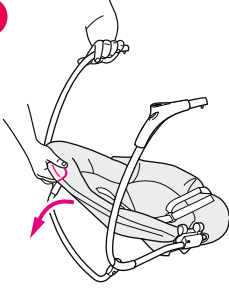

8

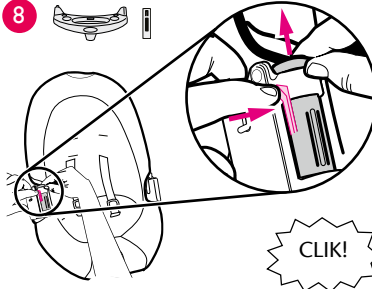

9



10

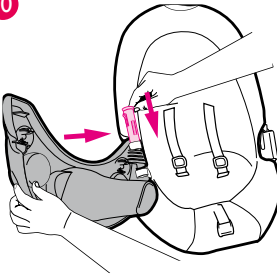

11

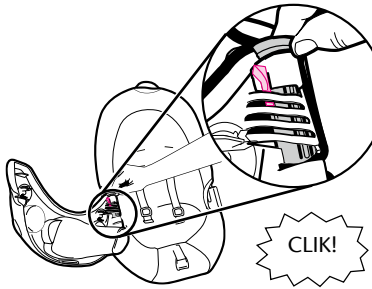

12

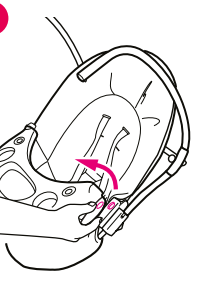

13

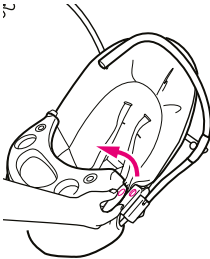

14

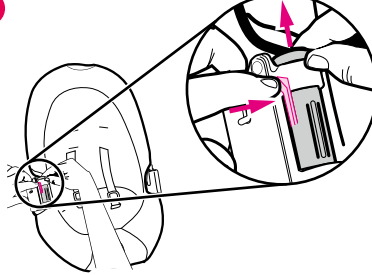

15

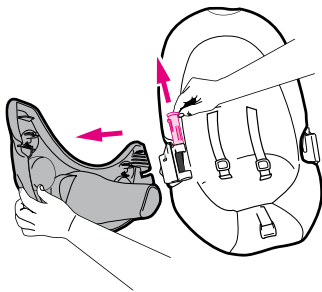

16

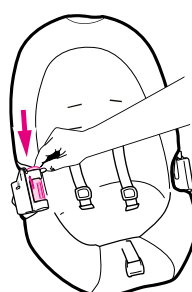

## Attaching Rear Legs

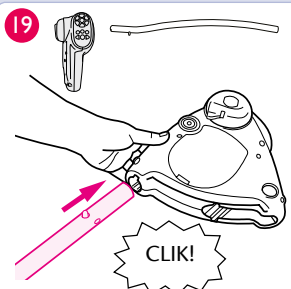
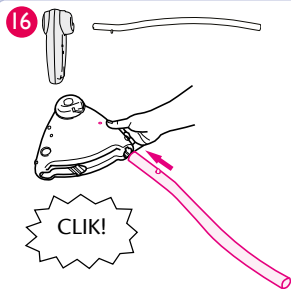

## Attaching Front Legs

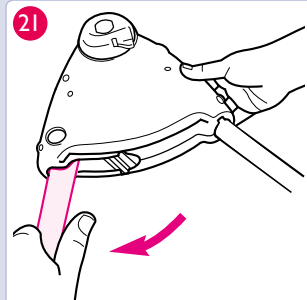
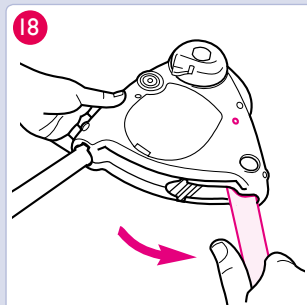
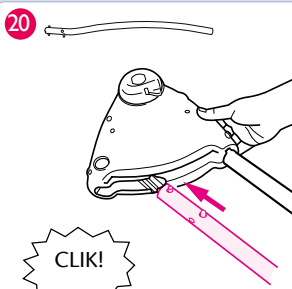
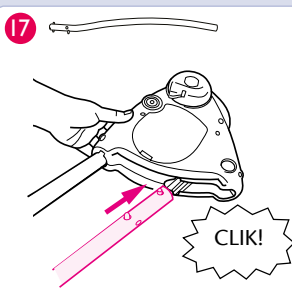

## Front Tube

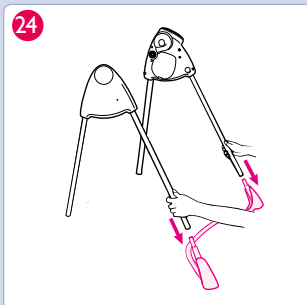
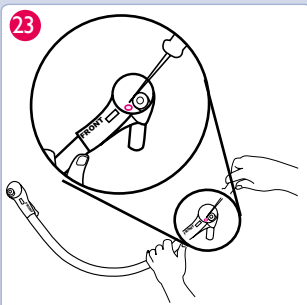
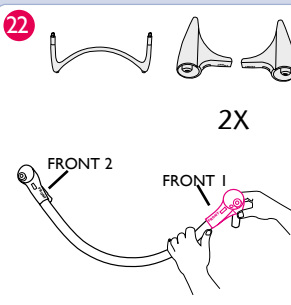

## Rear Tube

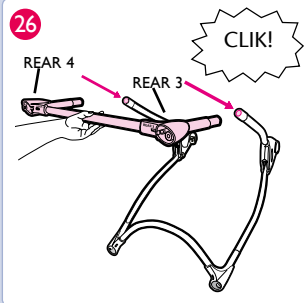
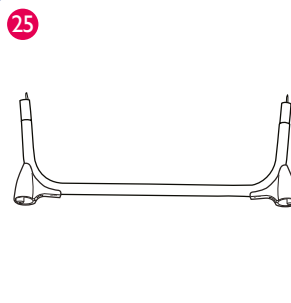

## To Secure Child

28

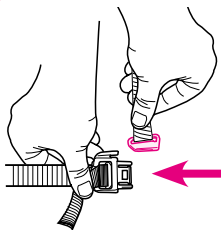

29

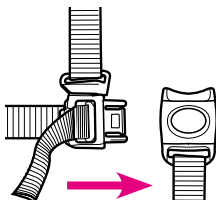

30

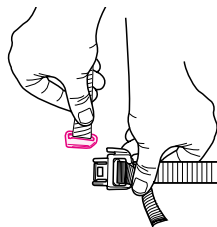

31

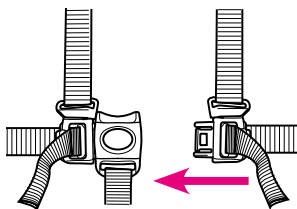

32

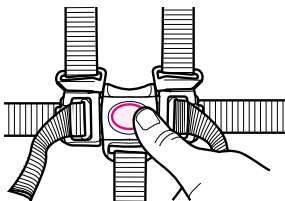

33

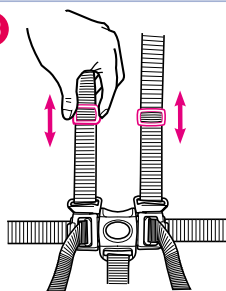

34



35



## To Adjust Recline

36

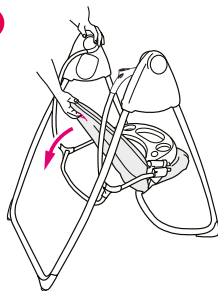

37

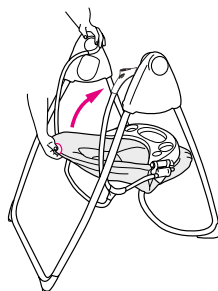

## Head Support

38

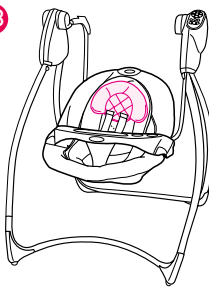

## Starting Swing

39

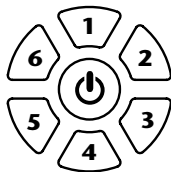

40



41



42



43

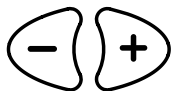

44



45



## For Storage

46

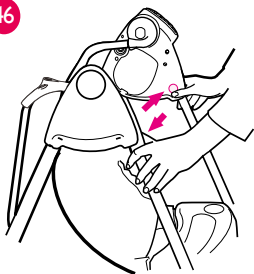

47

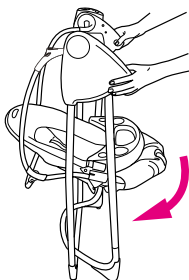

## Installing batteries

48

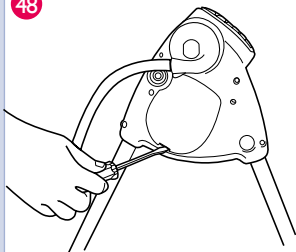

49

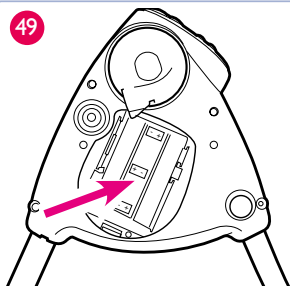

## Assembling Mobile

50

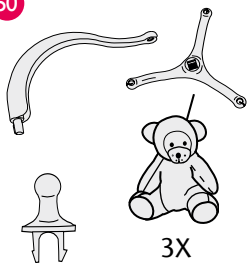

51

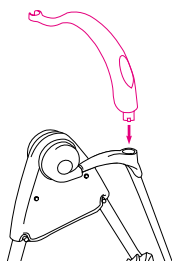

52

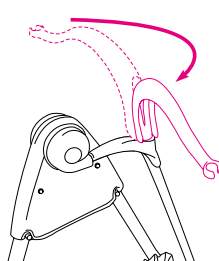

53

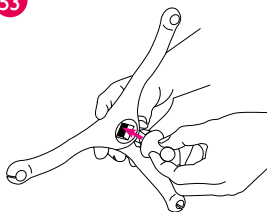

54

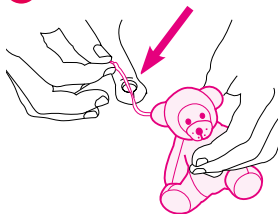

55

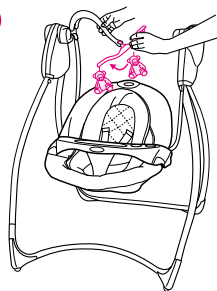

56

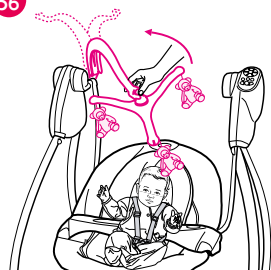

## Mix 'N Move Toys (on certain models only)

57

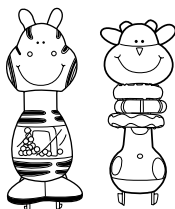

58

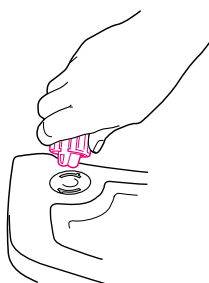

59

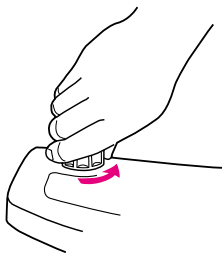

60

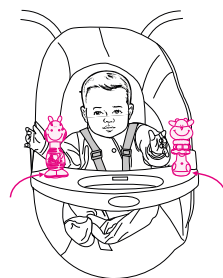

**GB IMPORTANT:** READ THESE INSTRUCTIONS CAREFULLY BEFORE USE AND KEEP THEM FOR FUTURE REFERENCE. YOUR CHILD'S SAFETY MAY BE AFFECTED IF YOU DO NOT FOLLOW THESE INSTRUCTIONS.

**F IMPORTANT :** LISEZ SOIGNEUSEMENT CES INSTRUCTIONS AVANT TOUTE UTILISATION ET CONSERVEZ-LES POUR VOUS Y REFERER ULTERIEUREMENT. S'VOUS NE LES RESPECTEZ PAS, LA SECURITE DE VOTRE ENFANT PEUT EN ETRE AFFECTEE !

**D WICHTIG:** VOR DER BENUTZUNG DES KINDERWAGENS DIESE ANLEITUNG UNBEDINGT SORGFÄLTIG DURCHLESEN UND AUFBEWAHREN. DIE SICHERHEIT IHRES KINDES KANN GEFÄHRDET SEIN, WENN SIE DIESE ANWEISUNGEN NICHT BEFOLGEN.

**NL BELANGRIJK:** LEES DEZE INSTRUCTIES ZORGVULDIG DOOR EN BEWAAR ZE TER REFERENTIE IN DE TOEKOMST. U KUNT DE VEILIGHEID VAN UW KIND IN GEVAAR BRENGEN ALS U DEZE INSTRUCTIES NIET LEEST.

**E IMPORTANTE:** LEA ESTAS INSTRUCCIONES DETENIDAMENTE ANTES DE UTILIZAR EL CARRITO Y GUÁRDALA PARA USOS FUTUROS. LA SEGURIDAD DEL NIÑO PUEDE verse COMPROMETIDA SI NO SE SIGUEN ESTAS INSTRUCCIONES.

**I IMPORTANTE:** LEGGERE ATTENTAMENTE QUESTE ISTRUZIONI PRIMA DELL'USO E CONSERVARLE PER RIFERIMENTI FUTURI. LA MANCATA CONSULTAZIONE DI TALI ISTRUZIONI PUÒ COMPROMETTERE LA SICUREZZA DEL VOSTRO BAMBINO.

**P IMPORTANTE:** LEIA ESTAS INSTRUÇÕES ATENTAMENTE ANTES DA UTILIZAÇÃO E GUARDE-AS PARA FUTURA REFERÊNCIA. A SEGURANÇA DO SEU FILHO PODE SER AFECTADA SE NÃO SEGUIR ESTAS INSTRUÇÕES.

**H FONTOS:** A HASZNÁLAT ELŐTT GONDOSAN OLVASSA ÁT EZEKET AZ UTASÍTÁSOKAT ÉS ÓRIZZ MEG AZOKAT KÉSŐBBI HIVATKOZÁS CÉLJÁBÓL, KEDVEZŐTLENÜL BEFOLYÁSOLHATJA GYERMEKÉNEK BIZTONSÁGÁT, HA NEM TARTJA BE EZEKET AZ UTASÍTÁSOKAT.

**SK DŮLEŽITÉ:** PŘED POUŽITÍM SI POZORNE PREČÍTAJTE NASLEDUJÍCÍ POKYNY A USCHOVÁJTE ICH PŘE DALŠÍE POUŽITIE. AK SA TÝMITO POKYNNI NEBUDETE RIADIŤ, MÔŽETE OHROZIŤ BEZPEČNOSŤ SVOJHO DIEŤAŤA.

**DK VIGTIGT:** LÆS BRUGSANVISNINGEN OMHYGGELIGT FØR KlapVOGNEN TAGES I BRUG OG GEM BRUGSANVISNINGEN TIL FREMTIDIG BRUG AF HENSYN TIL BARNETS SIKKERHED.

**S VIKTIGT:** LÄS DENNA BRUKSANVISNING NOGA FÖRE ANVÄNDNING OCH SPARA DEN FÖR FRAMTIDA BRUK. BARNETS SÄKERHET KAN PÅVERKAS OM INTE DESSA INSTRUKTIONER FÖLJS.

**FIN TÄRKEÄÄ:** LUE KÄYTTÖOHJE ENNEN KÄYTTÖÄ JA SÄILYTÄ SE MAHDOLLISTA TARVETTA VARTEN. JOS ET NOUDATA NÄITÄ OHJEITA, LAPSESI TURVALLISUUS SAATTA VAARANTUA.

**N VIKTIG:** LES DISSE INSTRUKSJONENE NØYE FØR BRUK OG OPPBEVAR DEM FOR SENERE BRUK. BARNETS SIKKERHET KAN KOMPRMITTERES HVIS DU IKKE FØLGER DISSE INSTRUKSJONEONE.

**RU ВАЖНО:** ВНИМАТЕЛЬНО ПРОЧИТЕ ДАННУЮ ИНСТРУКЦИЮ ДО НАЧАЛА ЭКСПЛУАТАЦИИ КОЛЯСКИ. СОХРАНИТЕ ИНСТРУКЦИЮ ДЛЯ ДАЛЬНЕЙШЕГО ИСПОЛЬЗОВАНИЯ. НЕСОБЛЮДЕНИЕ ПРИВЕДЕННЫХ ИНСТРУКЦИЙ МОЖЕТ ПОСТАВИТЬ ПОД УГРОЗУ БЕЗОПАСНОСТЬ ВАШЕГО РЕБЕНКА.

**PL WAŻNE:** PRZED PRZYSTĄPIENIEM DO UŻYTKOWANIA WÓZKA NALEŻY UWAŻNIE PRZECZYTAĆ NINIEJSZĄ INSTRUKCJĘ I ZACHOWAĆ JĄ NA PRZYSZŁOŚĆ. NIEPRZESTRZEGANIE INSTRUKCJI MOŻE NARAZIĆ BEZPIECZEŃSTWO TWOJEGO DZIECKA.

**EL ΣΗΜΑΝΤΙΚΟ:** ΔΙΑΒΑΣΤΕ ΠΡΟΣΕΚΤΙΚΑ ΤΙΣ ΠΑΡΟΥΣΕΣ ΟΔΗΓΙΕΣ ΠΡΙΝ ΑΠΟ ΤΗ ΧΡΗΣΗ ΚΑΙ ΦΥΛΑΞΤΕ ΤΙΣ ΓΙΑΤΙ ΘΑ ΣΑΣ ΦΑΝΟΥΝ ΧΡΗΣΙΜΕΣ ΣΤΟ ΜΕΛΛΟΝ. Η ΑΣΦΑΛΕΙΑ ΤΟΥ ΠΑΙΔΙΟΥ ΣΑΣ ΕΞΑΡΤΑΤΑΙ ΑΠΟ ΤΗΝ ΤΗΡΗΣΗ ΤΟΥΣ.

**CZ DŮLEŽITÉ:** PŘED POUŽITÍM SI PEČLIVĚ PŘEČTĚTE NÁSLEDUJÍCÍ POKYNY A USCHOVEJTE JE PRO DALŠÍ POUŽITÍ. POKUD SE TĚMITO POKYNY NEBUDETE ŘÍDIT, MŮŽETE OHROZIT BEZPEČÍ SVÉHO DÍTĚTE.

**HR VAŽNO:** PRIJE UPORABE PAŽLJIVO PROČITAJTE OVE UPUTE I ČUVAJTE IH RADI NAKNADNIH POTREBA. SIGURNOST VAŠEG DJETETA MOŽE BITI UGROŽENA AKO NE SLIJEDITE OVE UPUTE.



**RO IMPORTANT:** CITIȚI ACESTE INSTRUCȚIUNI CU ATENȚIE ÎNAINTE DE UTILIZARE ȘI PĂSTRAȚI-LE PENTRU REFERINȚĂ VIITOARE: SIGURANȚA COPILULUI DVS. POATE FI AFECTATĂ ÎN CAZ DE NERESPECTARE A ACESTOR INSTRUCȚIUNI.

**EE TÄHTISI:** LUGEGE KÄESOLEV KASUTUSJUHEND ENNE TOOTE KASUTAMIST HOOLIKALT LÄBI JA HOIDKE SEE ALLES EDASPIDISEKS KASUTAMISEKS: KASUTUSJUHENDI MITTE JÄRGIMINE VÕIB TEIE LAPSE OHTU SEADA.

**LT SVARBU:** PRIEŠ NAUDOJIMĄ, ATIDŽIAI PERSKAITYKITE ŠIĄ INSTRUKCIJĄ IR IŠSAUGOKITE JĄ KAIP NUORODĄ ATEICIAI: ŠIŲ NURODYMŲ NESILAIKYMAS GALI ĮTAKOTI JŪSŲ VAIKO SAUGUMĄ.

**LV SVARĪGI:** PIRMS LIETOŠANAS, LŪDZU, IZLASIET UZMANĪGI ŠO INSTRUKCIJU UN UZGLABĀJIET TO TURPMĀKAI ATSAUCEI. JA JŪS NEIEVĒROJAT ŠO INSTRUKCIJU, TAS VAR IETEKMĒT JŪSU BĒRNA DROŠĪBU.

**AR مهم:** قم براءة هذه الإرشادات بعناية قبل الاستخدام واحتفظ بها للرجوع إليها في المستقبل: قد تتأثر سلامة طفلك إذا لم تتبع هذه الإرشادات بعناية.

**HR/BIH VAŽNO:** PAŽLJIVO PROČITAJTE OVE UPUTE PRIJE UPOTREBE I SAČUVAJTE IH U SLUČAJU DA VAM USTREBAJU: SIGURNOST VAŠEG DJETETA MOŽE BITI UGROŽENA AKO NE SLIJEDITE OVE UPUTE.

**SRB VAŽNO:** PROČITAJTE PAŽLJIVO OVA UPUTSTVA PRE UPOTREBE I SAČUVAJTE IH ZA KASNIJU UPOTREBU: BEZBEDNOST VAŠEG DETETA MOŽE BITI UGROŽENA AKO NE SLEDITE OVA UPUTSTVA.

**SL POMEMBNO:** PRED UPORABO PAŽLJIVO PREBERITE TA NAVODILA IN JIH SHRANITE ZA PRIHODNJE. VARNOST VAŠEGA OTROKA JE LAHKO OGROŽENA, ČE NE BOSTE SLEDILI TEM NAVODILOM.

**TR UYARI:** KULLANMADAN ÖNCE BU TALİMATLARI DİKKATLİCE OKUYUN VE İLERİDE REFERANS OLARAK KULLANMAK İÇİN SAKLAYIN. BU TALİMATLARA UYMAZSANIZ ÇOCUĞUNUZUN GÜVENLİĞİNİ TEHLİKEYE ATABİLİRSİNİZ.

Failure to follow these warnings and the assembly instructions could result in serious injury or death.

**WARNING:** Always check the suspension system before use. Failure to follow this could result in falling down.

**PLEASE SAVE OWNER'S MANUAL FOR FUTURE USE.**

To prevent serious injury or death from child falling or being strangled in straps:

Always use harness.

**WARNING:** Never leave child unattended.

**WARNING:** Stop using product when child attempts to climb out or reaches 24.25 pounds (11 kg).

**WARNING:** It is dangerous to place this product on an elevated surface.

**WARNING:** Always use on a flat, level floor.

**WARNING:** This product is not intended for prolonged period of sleep. Should your child need to sleep, then place the child in a suitable cot or bed.

**WARNING:** Do not use the product without the seat cushion.

To be used from birth to 11 kg. Do not use for a child that weighs less than 5.5 pounds (2.5 kg), or a child premature or weakened – Use in most reclined position until child can sit up unassisted.

**STRANGULATION HAZARD:**

**WARNING:** Do not leave or place the product close to another product which could present a danger of suffocation or strangulation, e.g. strings, blind/ curtain cords etc.

Strings can cause strangulation. **DO NOT** place items with a string around your child's neck, such as hood strings or pacifier cords.

**DO NOT** suspend strings over the product or attach strings to toys.

**DISCONTINUE USING YOUR PRODUCT** should it become damaged or broken.

**WARNING:** Do not use the product if any parts are broken, torn or missing and use only spare parts approved by the manufacturer.

**WARNING:** Be aware of the risk of open fire and other sources of strong heat, such as electric bar fires, gas fires, etc. in the vicinity of the product.

This product requires adult assembly. Follow assembly instructions carefully. If you experience any difficulties, please contact the Customer Service Department.

**Transformer or batteries:** Product is not to be connected to more than the recommended number of power supplies.

**Electronic toys (on certain models):** Do not open. No serviceable parts inside. Remove and immediately discard plastic tab from slot in toy.

### **FOR SAFE BATTERY USE**

Keep the batteries out of children's reach.

Only the recommended batteries or equivalent are to be used, volts and size.

Batteries are inserted with the correct polarity.

Remove exhausted batteries from the product.

**DO NOT** short-circuit supply terminals.

Rechargeable batteries are to be removed from the toy before being charged.

Rechargeable batteries are only to be charged under adult supervision.

Any battery may leak battery acid if mixed with a different battery type, if inserted incorrectly (put in backwards) or if all batteries are not replaced or recharged at the same time. Do not mix old and new batteries. Do not mix alkaline, standard (carbon-zinc) or rechargeable (nickel-cadmium) batteries.

Any battery may leak battery acid or explode if disposed of in fire or an attempt is made to charge a battery not intended to be recharged.

Never recharge a cell of one type in a recharger made for a cell of another type.

Discard leaky batteries immediately. Leaky batteries can cause skin burns or other personal injury. When discarding batteries, be sure to dispose of them in the proper manner, according to your state and local regulations.

Always remove batteries if the product is not going to be used for a month or more. Batteries left in the unit may leak and cause damage.

Recommended type batteries—alkaline disposables, size D(LR20-1.5V). NEVER mix battery types. Change batteries when product ceases to operate satisfactorily.



The crossed out wheeled bin symbol indicates the product is to be recycled.

## CARE AND MAINTENANCE

FROM TIME TO TIME CHECK YOUR PRODUCT for loose screws, worn parts, torn material or stitching. Replace or repair the parts as needed. Use only Graco replacement parts.

REMOVABLE CLOTH SEAT COVER may be machine washed in cold water on delicate cycle and drip-dried. NO BLEACH.

TO CLEAN FRAME, use only household soap and warm water.

NO BLEACH or detergent.

Excessive exposure to sun or heat could cause fading or warping of parts.

## PROBLEM SOLVING

### Product won't operate:

1. No batteries in swing.
2. Batteries dead.
3. Speed setting too low.
4. Batteries in backwards — check "+" and "-".
5. Corrosion on battery terminals. Rotate batteries in place against terminals, or clean with sandpaper or steel wool if corrosion is severe.
6. Baby leaning too far forward.
7. Baby grabbing swing legs. (Discontinue use.)
8. Seat not pushed high enough for a good start.
9. Protective device activated. (Turn off motor, wait 3 minutes, then restart swing.)

### Seat doesn't swing very high:

1. Control setting too low.
2. Blanket hanging down, causing increased wind resistance.
3. Batteries too weak.
4. Baby leaning too far forward.
5. Baby too heavy or too active. (Discontinue use.)
6. Soft carpet (swings higher on hard floors).

## Assembling Product

See images 1 - 6

## Attaching Tray

See images 7 - 15

## Attaching Legs

- 16 The double buttons must fit into the channels inside the housings. Button **MUST** snap through hole.
- 17 Insert rear legs into holes in housing as shown. Button **MUST** snap through hole.  
REPEAT steps 10 through 12 with other housing and legs.
- 18 See image
- 19 Swing the legs outward until the single button snaps into its notch. CHECK that the legs are properly attached by twisting them in the housings.
- 20 - 21 See images

## Front Tube

- 22 Place feet with the text "FRONT" onto the front tube as shown. The text "FRONT" should face floor.
- 23 Secure front foot with screw. Repeat on other side.
- 24 Snap front tube onto swing legs. CHECK that all tubes are securely attached.

## Rear Tube

- 25 See image
- 26 Place feet with the text "REAR" onto the rear tube as shown. The text "REAR" should face floor. Secure foot with screw. Repeat on other side. Snap hangar tubes into brackets on each side of housing.
- 27 CHECK that hangar tubes are secure in brackets by pulling firmly on them.

## To Secure Child

See images 28 - 32

- 33 Use slide adjuster at shoulder and waist for further adjustment. Repeat on other side.
- 34 When changing harness strap slots, **MAKE SURE** harness straps are going through same slots in seat pad.
- 35 The harness straps must go into the slot that is even with or slightly above the shoulders. Avoid twisting straps.

## To Adjust Recline

See images 36 - 37

## Head Support

- 38 Only use this head support on this swing. Never use this head support on any other product.

## Starting Product

**WARNING:** avoid serious injury from falling or sliding out. Always use harness. After fastening buckles, adjust belts to get a snug fit around your child.

**TO TURN PRODUCT ON:** Press On /Off button or press any speed from 1 to 6. When pressing On/Off button, it automatically starts with the last speed setting that was selected before the product was turned off.

Observe the swinging motion for a minute. It takes time for the product to adjust to a setting. Change setting if needed.

A small, quiet baby will swing higher on each setting than a larger, more active baby.

Your seat may be stopped at any time the motor is running without damaging the motor. Push product to restart.

If your product motor stops operating by itself, a protective device may have been activated. Turn off motor, wait three minutes, then restart swing.

**TO TURN PRODUCT OFF:** Press On /Off button.

## Button Functions

- 39 SPEED – Press On /Off button or press any speed from 1 to 6. When pressing On/Off button, it automatically starts with the last speed setting that was selected before the swing was turned off.
- 40 ON/OFF POWER - Press to turn ON and turn OFF. Press button to stop swing motion.
- 41 MUSIC - Push “Music” button to turn on music. Push button again to advance to next track. There are 10 songs.
- 42 MUSIC/NATURE OFF - Press button to turn OFF.
- 43 VOLUME— Press the plus (+) to raise the volume and the minus (-) to lower the volume. There are 5 volume settings.
- 44 NATURE SOUNDS— Push “Nature” button to turn on nature sound selection. Each press will change to the next nature sound. After the 5th sound is selected, it will return to the first track.
- 45 TIMER— Push “Timer” button to set the timer for the swing and/or Music/Nature sounds. If the timer button is not pushed, the swing and/or music/nature sound will continue to play until the power on/off button is pushed or the music/nature off button is pushed.

When using the timer with the product on, if the button is pushed once, the red speed light will flash once and timer is set for 10 minutes. Pushing the timer button a second time will increase the run time to 20 minutes and the red speed light will flash twice.

Pushing a third time will increase the time to 30 minutes and the red speed light will flash three times.

When using the timer with the Music/Nature sounds on, the timer will set to 10, 20 or 30 minutes as described for the swing, but there will be no flashing light.

## Storage

See images 46 - 47

- 46 Push buttons to fold.

## Installing Batteries

- 48 With baby out of swing, open the battery compartment lid by inserting a screwdriver into the coin slot. Insert three “D”-LR20 (1.5V) cell batteries.
- 49 CHECK that the batteries are put in correctly. Your swing will not run if the batteries are put in backwards.

## Assembling Mobile

See images 50 - 56

## Mix N’ Move Toys

See images 57 - 60



UK Graco consumer Services  
Newell Rubbermaid  
Graco Children's Products  
Halifax Avenue  
Fradley Park  
Lichfield WS13 8SS  
United Kingdom  
44844 412 1212

Graco Continental Europe  
Newell Rubbermaid Luxembourg SARL  
1 rue Edmond Reuter  
L-5326 CONTERN  
Luxembourg

[www.gracobaby.eu](http://www.gracobaby.eu)

[www.graco.co.uk](http://www.graco.co.uk)