

valco
baby

PRODUCT REFERENCE GUIDE

ZEE
Stroller



© Copyright
VE 2012
vs130212

FURTHER INFORMATION:
www.valco.com.au

Find us on:





ZEE

Stroller

Thank you for purchasing a quality
VALCO BABY product.

Please read and follow the instructions
outlined in this guide carefully. Familiarise
yourself with the construction and safety
features; be sure that you understand all
the warnings and safety
guidelines before use.



**Important: Please read the following
instructions carefully before
assembling this product. Retain
this guide in a safe place for future
reference.**



DISCLAIMER

Due to our policy of continuous product development, this product is constantly evolving. It is possible that some features or procedures outlined here have changed since this document was written. If you are unsure of any procedure shown here, please contact us via the web at info@valco.com.au to obtain the most up to date information before use. Include the batch number and model number, which can be found on a sticker on the frame.

All pictures and diagrams herein are provided for illustration purposes only. Actual product, colour or fabric may vary. VALCO BABY reserves the right to modify or alter any specification or colour without notice or obligation to modify any product previously purchased

1>PARTS LIST

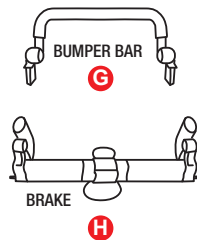
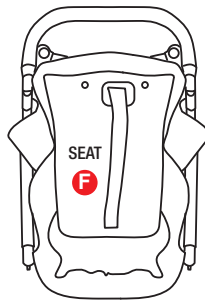
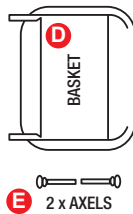
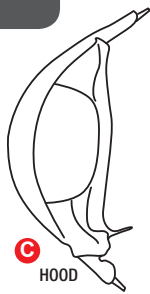
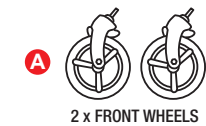

2>TO OPEN

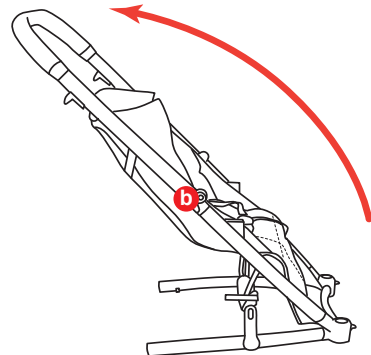
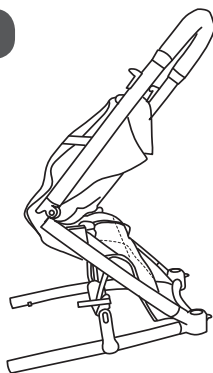
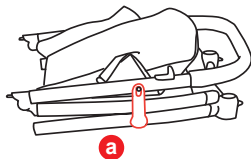

3>REAR AXLE

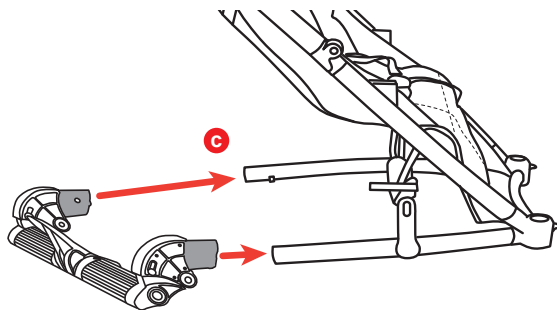

4>BASKET

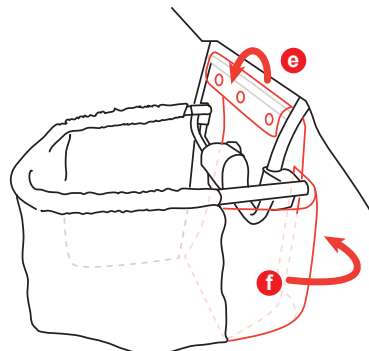
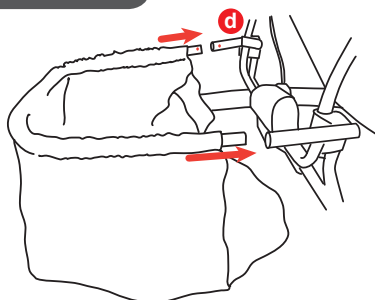

5>REAR WHEELS

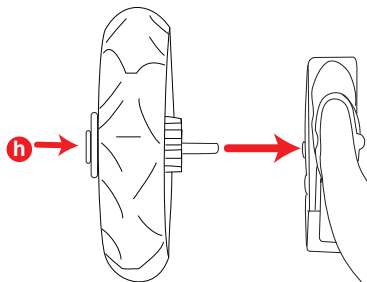
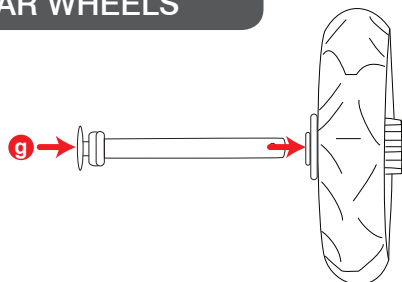

6>FRONT WHEELS

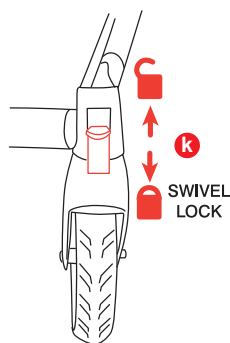
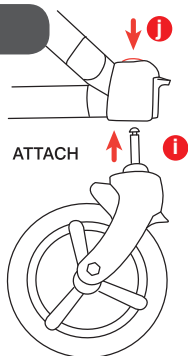

7>BUMPER BAR

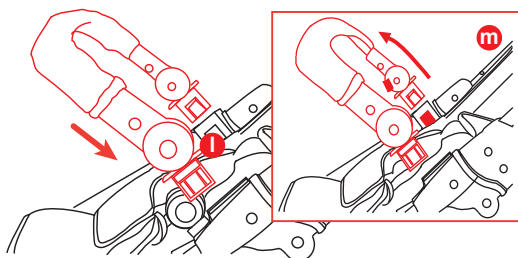

8>FOOTREST

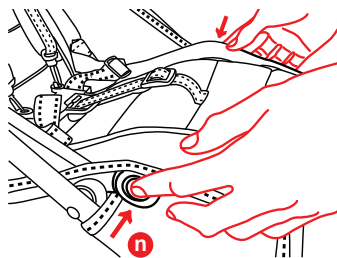

9>SEAT RECLINE

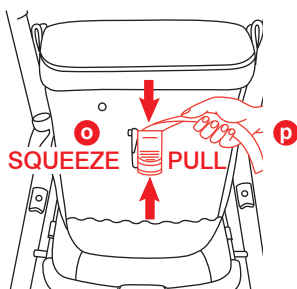

10>BRAKES

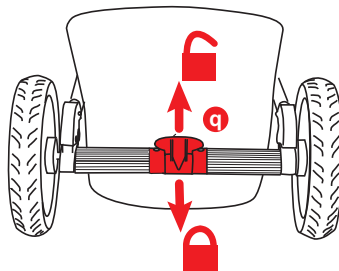

11>HOOD

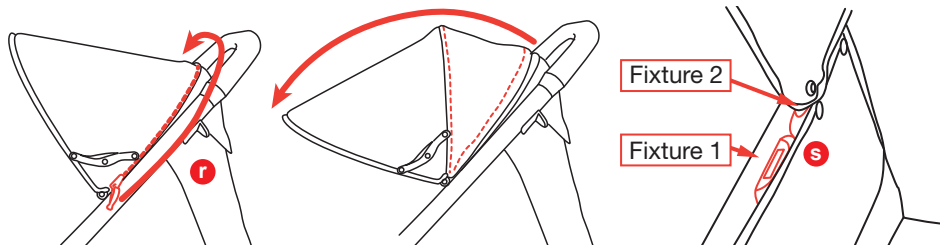

12>HARNESS

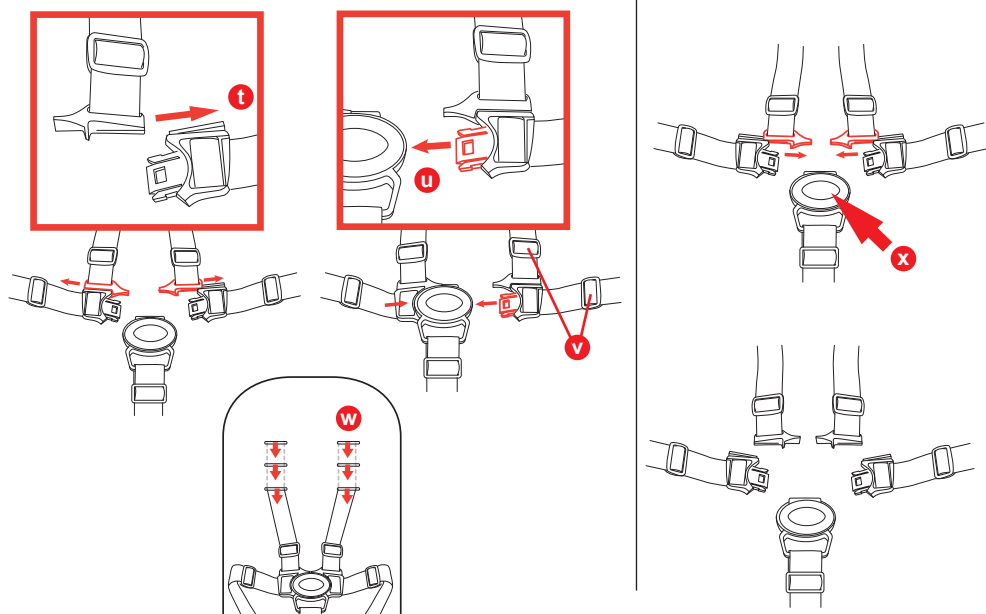

13>FOLDING

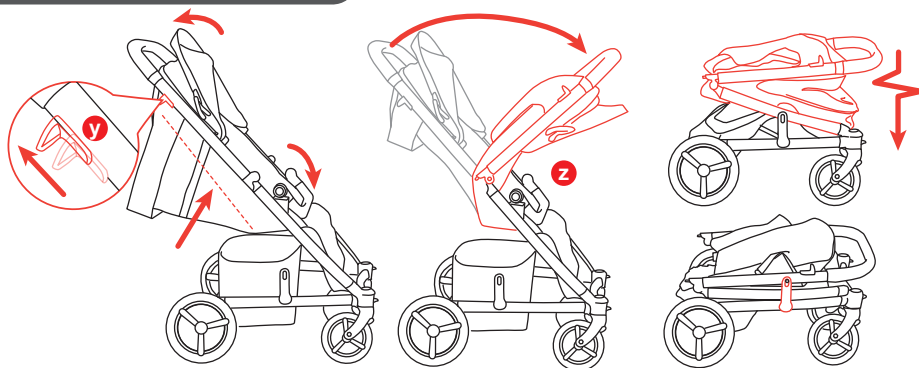

INSTRUCTIONS

1>PARTS LIST

Remove the stroller from the carton and dispose of all packaging thoughtfully. Check contents: 1x hood, 1x bumper bar, 1x basket, 2x front wheels, 2x rear wheels, 2x axles, 1x brake, 1x seat.

2>TO OPEN

Release frame lock on side of stroller frame (a).

Lift the stroller handle upward and over in one continuous motion until the lower chassis locks into position (b). (You should hear an audible 'click').

IMPORTANT WARNING: ALWAYS TEST THAT ALL LATCHES ARE SECURELY ENGAGED BEFORE USE.

3>REAR AXLE

Align the plastic housings of the rear brake section with the open tubes of the rear of the stroller chassis (c) .

⚠IMPORTANT WARNING : BE SURE THAT THE RED BRAKE LEVER IS UPRIGHT

Insert the housings over the open tubes until the brake section locks securely into place.

⚠IMPORTANT WARNING: TEST THAT THE BRAKE SECTION IS SECURELY ENGAGED ONTO THE STROLLER FRAME BY PULLING ON IT FIRMLY.

4>BASKET

Align the basket frame with the open tubes at the rear of the seat. Simultaneously pressing in the locking buttons (d), slide the basket frame into the housing until the buttons lock into place.

Basket front - pass the front flap over the bar between the seat and the seat frame (e). Secure with the snaps. Pull the side flaps around the front and Velcro into place on the front flap (f).

5>REAR WHEELS

Simultaneously press on the spring loaded axle button (g) and insert it through the central hub of the rear wheel. Repeat this process for the other rear wheel.

Pressing the axle button again (h), insert the axle end into the side of the brake housing as far as it will go. Release the axle button and pull slightly on the wheel to ensure that it has securely engaged.

6>FRONT WHEELS

Grasping the front wheel, align the shaft with the hole in the underside of the swivel housing (i). Depress the button on the top of the swivel housing (j). Insert the shaft into the housing as far as it can go until it engages securely.

Repeat the procedure for the other front wheel.

IMPORTANT: Pull the wheel downward to test THAT IT HAS SECURELY ENGAGED IN THE HOUSING.

Locking your wheels: Your front wheels can be set to swivel freely (360°) or can be fixed in place for use over rough or sandy surfaces.

To fix the front wheel in the non swivel position, turn the wheel so that the two notches on both housings line up. Press down firmly on the swivel lock until it locks into place (k).

To unlock simply lift the locking tab until it locks in the open position.

7>BUMPER BAR

Insert the front bar ends into the nylon housings located on either side of the frame. Be sure that the bar is securely engaged.

Adjust the front bar by simultaneously pressing the button on the bar housing and swivelling the bar to the uppermost position (l). This is the only position for use with a child in the stroller.

To remove the front bar: Feeling the side of the nylon housing that sits below the frame at each side (facing inward), locate the release button (m). Press each release button inward while simultaneously pulling upward on the bar housing. Repeat for the other side. Note that this may be difficult to do as the bar is secured firmly as a safety precaution.

⚠IMPORTANT WARNING: THE FRONT BAR IS NEITHER A RESTRAINING NOR CARRYING DEVICE.

8>FOOTREST

To adjust your foot rest downward, press the central buttons on either side of the footrest while simultaneously adjusting it up or down(n).

⚠IMPORTANT WARNING: YOUR FOOTREST IS DESIGNED TO COLLAPSE IF EXCESS WEIGHT IS APPLIED TO IT

9>SEAT RECLINE

To recline: While squeezing the seat adjuster tabs (o) together in a pincer like movement, ease the seat down to the desired position. Release the tabs and the seat will

automatically lock in that position

To incline: Place your hand in the centre of the seat at the rear.

Pull the incline strap (p) while gently pushing the seat upward to the desired position.

10>BRAKE

To engage the brake press down on the central red brake pedal (q), until the brakes engage fully into the wheel cogs.

To disengage, simply reverse the process.

11>EXPANDA HOOD

The Expanda hood unzips, increasing the size of your standard hood to give greater coverage and protection from the sun and weather for your child.

To open the Expanda Hood: Locate the zip in the center of the Expanda Hood and unzip completely (r). Gently pull the Expanda Hood forward until it reaches its full extension.

To close the Expanda Hood: Gently push the Expanda Hood back, allowing the middle section to fold in on itself. Carefully zip the Expanda Hood closed.

The hood offers two height positions to allow for your child's growth (s). To increase the height of the hood simply move the hood to the second fixture.

12>HARNESSES

Your stroller harness is specifically designed with many built in safety features.

This includes the requirement that, when opened, all straps are released so that no dangerous loops can be formed causing a strangulation hazard.

⚠WARNING: YOUR CHILD MUST ALWAYS BE HARNESSSED WHEN IN THE STROLLER

Closing your harness:

Slide each of the shoulder strap bottom guides (t) into the corresponding channel on the top of each side strap prong.

Insert each completed prong into the central buckle housing (u).

Carefully adjust the harness straps to snugly fit your child by adjusting the sliders (v) located on each strap. The harness should be fitted to your child's body, tight enough so that they cannot wriggle free of the straps but, loose enough, so as not to cause any discomfort.

For even more flexibility, the height at which your shoulder straps are fitted to the stroller can be adjusted at 3 points. To change the shoulder strap position:

From the rear of the seat, thread the top of the strap back through the harness slot (w) by manoeuvring the locking ring so that it fits through the slot.

Rethread the strap back through the desired slot from the front of the seat

Opening your harness:

Press the central housing button (x).

This will release both side prongs from the central housing. The shoulder and waist straps will release automatically from each other.

If the shoulder and waist straps do not automatically disengage from each other, manually slide the guides of the waist channels. Your harness will separate into 5 sections.

⚠IMPORTANT WARNING: WHEN NOT IN USE, BE SURE THE SHOULDER AND WAIST STRAPS ARE ALWAYS DISCONNECTED FROM THE CENTRAL HOUSING AND EACH OTHER.

13>FOLDING

To ensure maximum compactness, prior to folding your stroller:

- fold the hood closed back against the handle
- incline the seat
- lower the bumper bar
- remove all contents from the basket

Locate the frame release (y) on either side of the handle. Lift the frame release buttons on either side of the handle simultaneously upwards.

Swing the handle forward. As the handle passes the fold joint (z), you will feel the lower chassis release and fold downward in a 'z' shape.

Push the frame down completely until the frame lock engages.

WARNING: TO AVOID INJURY OR DEATH

- ALWAYS APPLY THE BRAKES WHENEVER THE PRAM/STROLLER IS STATIONARY
- DO NOT LEAVE CHILDREN UNATTENDED.
- SECURE THE CHILD IN THE HARNESS AT ALL TIMES.
- DO NOT CARRY EXTRA CHILDREN OR BAGS ON THIS PRAM/STROLLER.
- MAKE SURE CHILDREN ARE CLEAR OF ANY MOVING PARTS IF YOU ADJUST THE PRAM/STROLLER. OTHERWISE THEY MAY BE INJURED.

 **WARNING: USE THIS HARNESS AT ALL TIMES.**

 **WARNING: WHEN NOT IN USE DISCONNECT SHOULDER STRAPS FROM THE WAIST STRAP AND/OR BUCKLE.**

- FOLLOW THE MANUFACTURER'S INSTRUCTIONS.

Remember, your child's safety is your responsibility...

- NEVER USE ON STAIRS OR ESCALATORS.
- ALWAYS USE THE TETHER STRAP WHEN THE STROLLER IS IN USE.
- THE CORRECT USE AND MAINTENANCE OF THIS VEHICLE ARE ESSENTIAL.
- BE SURE THAT ALL CLAMPS AND BUCKLES ARE SECURELY FIXED AND IN PLACE BEFORE USE
- WHEN IN THE STROLLER, YOUR CHILD MUST ALWAYS WEAR THE SAFETY HARNESS, CORRECTLY FITTED AND ADJUSTED, AT ALL TIMES.
- ALWAYS USE THE HARNESS, CORRECTLY FITTED AND ADJUSTED, WITH YOUR CHILD IN THIS SEAT.
- THE MAXIMUM WEIGHT OF THE CHILD FOR WHICH THIS STROLLER WAS INTENDED IS 19.9KGS (39LBS).
- THE MAXIMUM HEIGHT OF THE CHILD FOR WHICH THIS STROLLER WAS INTENDED IS 90CM (35INCHES).
- THE STROLLER MAY BECOME UNSTABLE IF THE MANUFACTURER'S RECOMMENDED LOAD IS EXCEEDED.
- CARE MUST BE TAKEN WHEN FOLDING AND UNFOLDING THE PRODUCT TO PREVENT FINGER ENTRAPMENT.
- CAN BE USED FROM A NEWBORN BABY ONWARDS. A COCOON, SPECIALLY DESIGNED TO BE USED WITH A STROLLER, IS RECOMMENDED WHEN ANY FULLY RECLINING STROLLER IS USED WITH A NEWBORN.
- NEVER RUN WITH A NEWBORN BABY IN ANY PRAM OR STROLLER UNTIL THE CHILD CAN SIT UP UNASSISTED (APPROXIMATELY 6 MONTHS).
- CHECK ALL PARTS BEFORE USE FOR BREAKAGE OR FATIGUE. DISCONTINUE USE IMMEDIATELY IF ANY PART IS FOUND TO BE DAMAGED OR BROKEN.
- MAXIMUM LOAD OF BASKETS: 3.5KGS.
- DO NOT CARRY ADDITIONAL CHILDREN. THIS STROLLER IS MANUFACTURED FOR THE USE WITH ONE CHILD ONLY
- ALWAYS BE AWARE OF THE RISKS PROVIDED BY FIRE AND OTHER SIGNIFICANT SOURCES OF HEAT SUCH AS RADIATORS, ETC. WHICH MAY BE IN THE IMMEDIATE VICINITY OF YOUR STROLLER.
- IT MAY BE UNSAFE TO USE ANY ACCESSORIES OTHER THAN VALCO BABY APPROVED ONES.
- THIS PRODUCT IS INTENDED FOR DOMESTIC USE ONLY. IT IS NOT INTENDED FOR COMMERCIAL USE.

Should the chassis become wet, dry off promptly before storing. If this pram is used near the ocean or salted roads, spray the chassis and seat frame with water and dry. We recommend a rust inhibiting product should be used to prevent rust and fatigue on metal parts.

We recommend that you wipe down axles and lubricate the wheels every 3 months. Sand and dirt can grind down axles, if you live near the beach or in a dusty environment you must wipe down the axles and wheels then lubricate them monthly.

AXLES ARE BEST LUBRICATED WITH GREASE OR PETROLEUM JELLY. MOVING PARTS ARE BEST LUBRICATED WITH SILICONE BASED PRODUCTS. DO NOT USE OIL BASED PRODUCTS.